



CCIH

Annual Conference

Strengthening Global Health: Faith at the Center

July 13-15, 2017 | Johns Hopkins University | Baltimore, Maryland, USA

Share the Experience #CCIH2017

@CCIntlhealth on



Sponsored by

LIBERTY
UNIVERSITY
DEPARTMENT of PUBLIC
& COMMUNITY HEALTH

Samaritan's Purse[®]
INTERNATIONAL RELIEF

 **NOVARTIS**

 **americares**

ProLife OBIGYNS
AAPLOG American Association of Pro-life
Obstetricians & Gynecologists

FAITH
for international
Assistance

 **IMA**WorldHealth

WORLD SERVICE OFFICE

imres

SANRU[®]

SIM

Loma Linda
University
School of
Behavioral Health

Program-At-A-Glance

Thursday, July 13	Friday, July 14	Saturday, July 15
7:00am–Midnight Housing Check-in 1st Floor North Charles Street Entrance	7:00am–Midnight Housing Check-in (1st Floor North Charles Street Entrance)	8:00am–Final Plenary Registration (2nd Floor East 33rd Street Entrance)
7:00am–7:00pm Registration (2nd Floor East 33rd Street Entrance)	7:00am – 4:00pm Registration (2nd Floor East 33rd Street Entrance)	7:00–8:30am Breakfast (Nolan's Dining Hall)
7:00–8:30am Breakfast (Nolan's Dining Hall)	7:00–8:30am Breakfast (Nolan's Dining Hall)	8:00–10:00am Check Out (1st Floor North Charles Street Entrance)
8:00am–1:00pm Youth Pre-Conference (Salons B & C) (<i>Simple Breakfast and Boxed Lunch Provided</i>)	8:30–10:35am Morning Praise and Plenary 2 (Salons B & C)	9:00–11:00am Worship and Plenary 4 (Salons B & C)
	10:35–11:00am Exhibits and Refreshments (Salon A, Salons B & C, and the Barber Room)	11:00–11:15am Exhibits (Salon A, Salons B & C, and the Barber Room)
	11:00am–Noon Breakout Session 1 1A Christians Respond to Violence, Stigma & Lack of Care for Women (Salons B & C) 1B Reports from the Field: Health Systems Strengthening & FBOs (East Room) 1C Standing on Holy Ground: The Spirituality of Care (Multi-Purpose Room)	11:15am–12:15pm Breakout Session 3 3A FBOs Share M&E & HSS Challenges, Successes & Lessons Learned (Salons B & C) 3B Faith-based Leadership on Climate Justice: A Moral Imperative (East Room) 3C Holistic Faith-based Approaches to Healing Trauma and Building Healthy Families (Multi-Purpose Room)
Noon–1:00pm Lunch (Nolan's Dining Hall)	Noon–1:00pm Lunch (Nolan's Dining Hall)	12:15–1:15pm Lunch (Nolan's Dining Hall)
1:15–4:00pm Monitoring & Evaluation Pre-Conference (Multi-Purpose Room)	1:00–1:30pm Exhibits (Salon A, Salons B & C, and the Barber Room)	1:15–2:00pm Exhibits (Salon A, Salons B & C, and the Barber Room)
	1:30–2:30pm Breakout Session 2 2A Advocacy, Empowering Faith Groups & Managing Imperfect Testing in HIV (Salons B & C) 2B Family Planning in Uganda & Senegal with Catholics & Protestants (East Room) 2C Faith Groups Reaching the Last Mile with Care (Multi-Purpose Room)	2:00–3:00pm Breakout Session 4 4A Faith Leaders as Powerful Allies in Improving Maternal and Child Health (Salons B & C) 4B Lessons from HIV and Malaria for Faith-based Organizations in Africa's Transition to Managing NCDs (East Room) 4C Responding in a Time of Multiple Famines (Multi-Purpose Room)
	2:30–2:45pm Exhibits and Refreshments (Salon A, Salons B & C, and the Barber Room)	3:00–3:30pm Exhibits and Refreshments (Salon A, Salons B & C, and the Barber Room)
	2:45–4:10pm Plenary 3 (Salons B & C)	3:30–4:00pm Working Groups Meet (Salons B & C and East Room) (<i>Check Full Schedule for locations</i>)
4:00–5:00pm Break/Dinner On Your Own	4:10pm Group Photo	4:00–5:45pm Presentation of Champion Award and Closing Plenary (Salons B & C)
5:00–5:30pm Opening Worship	4:30–5:30pm Annual Business Meeting (Salons B & C)	Dinner On Your Own
5:30–7:00pm Opening Plenary (Salons B & C)	5:30–6:00pm Working Groups Meet (Salons B & C)	
7:00–9:00pm Welcome Reception (Salon A, Salons B & C, and the Barber Room)	Dinner On Your Own	
	8:00 pm Screening of Facing Darkness Movie (Salons B & C)	



Strengthening Global Health: Faith at the Center

*May your constant love be with us, Lord, as we put our hope in you.
—Psalm 33:22*

In the midst of every global health crisis, we are called to minister to those around us. This year's theme speaks to the core of CCIH's mission: integrating our faith with our work in health. We will explore how our Christian faith guides our work, and examine questions such as:

- What is our role as Christians in ensuring all people have access to community-based care and preventive services, especially marginalized communities?
- What programs have we launched that protect and empower women and children and strengthen families?
- And finally, how do we sustain and strengthen evidence-based and people-centered health systems to ensure high-quality care for all?

TABLE OF CONTENTS

About CCIH/Staff and Board of Directors	3
Welcome from the CCIH Executive Director	5
At the Conference: Tips and Helpful Information	6
List of Nearby Restaurants	9
Map of the Johns Hopkins University Campus	11
Map of Charles Commons Lodging	12
Map of Charles Commons Session Rooms	13
Guide to Exhibitor/Sponsor Booth Locations	14
Theme Tables at Meals	13
Schedule: Day 1	16
Schedule: Day 2	22
Schedule: Day 3	34
Conference Planning and Review Committees	49
Speaker and Moderator Bios	50

Thanks to Our Sponsors

CCIH thanks the following organizations for their support of the Conference.

Gold Level —



Silver Level —



Bronze Level —



Thanks to the following sponsors for providing support for our Welcoming Reception, Lunch on Friday and the Youth Preconference.

Reception Sponsors



Lunch Sponsor



Youth Preconference



Scholarship Supporters

Thanks to our generous scholarship donors who helped support the attendance of students and developing country professionals through the General Conference Scholarship and the Luann and Ray Martin Maternal and Child Health Scholarship.

About CCIH

Christian Connections for International Health (CCIH) is a network of individuals and organizations from across the globe committed to promoting global health and wholeness from a Christian perspective. The CCIH Annual Conference is an opportunity to learn, network, share information and best practices and to join in Christian fellowship for students and global health professionals.



Contact Us

Bob Bleses, Interim Executive Director
Emily Boccia, Member Relations Coordinator
Mona Bormet, Program Director
Randall Cook, Operations Officer
Kathy Erb, Communications Manager
Kathryn Parker, Project Coordinator

bob.blees@ccih.org
emily.boccia@ccih.org
mona.bormet@ccih.org
randall.cook@ccih.org
kathy.erb@ccih.org
kathryn.parker@ccih.org

2016-2017 Board of Directors

Officers

Anne Peterson, MD, MPH, AmeriCares
Doug Fountain, MPA, Medical Teams International
David Olson, Olson Global Communications
Chad Hayward, Accord Network

President
Vice President
Secretary
Treasurer

Members

Dennis Cherian, MD, MHA, World Vision
Amy Gopp, MDiv, IMA World Health
Amy Hewitt, International Aid
Ronald Mataya, MD, MPH, Loma Linda School of Public Health
Paul Mikov, MA, Catholic Medical Mission Board
Pamela Mukaire, DrPH, Global Health Consultant
Lance Plyler, MD, Samaritan's Purse
Gordon Raley, Family Service Foundation
Bob Bleses, CCIH, Ex Officio

CCIH | ABOUT US

Thank you for joining us!



Bob Bleses



Randall Cook



Mona Bormet



Kathy Erb



Kathryn Parker

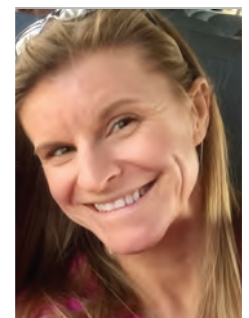

Emily Boccia





ANSWERING THE CALL. ANYTIME. ANYWHERE.

SAMARITAN'S PURSE offers a variety of opportunities for medical professionals to help save lives and share the love and compassion of the Great Physician, Jesus Christ.

- › CRITICAL MEDICAL CARE during a DISASTER RESPONSE
- › WORLD MEDICAL MISSION POST-RESIDENCY PROGRAM & SHORT-TERM PLACEMENT
- › CLEFT LIP AND PALATE SURGERY › CATARACT EXTRACTION
- › CHILDREN'S HEART PROJECT › MATERNAL CHILD HEALTH › NUTRITION

› VISIT OUR BOOTH
or go to samaritanspurse.org

Samaritan's Purse®
INTERNATIONAL RELIEF

Samaritan's Purse®, Franklin Graham, President
P.O. Box 3000, Boone, NC 28607 | 1-800-528-1980 | samaritanspurse.org
 SamaritansPurse  @SamaritansPurse  @SamaritansPurse
© 2017 Samaritan's Purse. All rights reserved.

Welcome from Bob Blees, Interim CCIH Executive Director

Welcome to CCIH's 31st Annual Conference! We are delighted to be at Johns Hopkins University once again and even happier that you chose to join us.

This year's theme, ***Strengthening Global Health: Faith at the Center*** speaks to the very reason we serve. We have the privilege of meeting together for this conference to strengthen the ideals that we all practice, and help each other to be reminded of the most important reason we serve. Effectively incorporating our faith into our practice, every day, is paramount to our success as Christian health workers. We pray that the next few days will be a wonderful time learning and sharing to make our efforts even more effective and lasting.



Those attending the conference this year will be blessed in a unique way, as we hear from men and women of faith who are living out what it means to put their faith into their practice. One of the highlights of this conference that you will not want to miss is the testimony of Dr. Kent Brantly as he recounts the call of God on his life, and the near death experience he had during the 2014 Ebola outbreak in West Africa.

We will explore the role of the Church and our personal faith walk in the plenary sessions. The opening plenary session: Health Systems Strengthening and Faith-based Organizations will challenge and draw us into thinking in a unique way about our role in health systems from a faith perspective. Plenary sessions two and three speak to the Church's role in primary care and guiding our youth as they navigate life's challenges. On Saturday morning we have the unique privilege of hearing from Dr. Kent Brantly himself about his faith journey. And, the final plenary session will help us learn more about the partnerships that can support our work and help us reach even more people in need.

The breakout sessions throughout the conference feature speakers from a variety of environments and backgrounds and give us the opportunity to share our ideas, successes and challenges in a smaller forum.

Enjoy the next few days celebrating 31 years of CCIH growth and accomplishments and fellowship with brothers and sisters in Christ! We hope that you make new friends, renew old acquaintances, learn a lot, and find encouragement from God's Word and from His people.

A handwritten signature in black ink that reads "Robert J. Blees". The script is fluid and cursive, with a large initial 'R'.

Bob Blees

CCIH Interim Executive Director

At the Conference: Helpful Information

Onsite Emergency Contact

If you encounter a problem immediately before, during or after the conference, please call us at 703-444-8250.

Social Media

Share your conference experience on social media! Tweet or post photos, interesting facts, inspiring comments or stories and more using #CCIH2017 on Twitter, Facebook and Instagram. Find CCIH @CCIntlhealth on all three platforms.

Photography Policy

Conference attendees are permitted to use cameras or smartphones to take photographs at the 2017 CCIH conference for personal (non-commercial) use, provided the photography is not disruptive to other attendees or to presenters (for example, does not obstruct views or make loud noises or bright flashes). These photographs may not be sold. Video recordings are not permitted for the general public at any time without the expressed written consent of CCIH.

CCIH Photographs, Audio and Video Recordings

By attending CCIH events, you consent to having your image and voice captured by CCIH photographers and videographers and on audio recording devices. The resulting materials, including still photographs, video, and audio recordings may be used, without restriction, by CCIH in articles, promotional materials, and on the CCIH website and social media sites. Please contact Kathy Erb at kathy.erb@ccih.org with questions regarding this policy.

Content Disclaimer

The views expressed by conference speakers, sponsors, advertisers or attendees do not necessarily reflect the views of Christian Connections for International Health. Goods endorsed by conference speakers, sponsors, advertisers or attendees are not endorsed by CCIH.

Wireless Connectivity

Johns Hopkins's wireless network for conference attendees is "JHGuestnet". Upon selecting the network, you will need to enter your email address. Once your email address is entered you may begin using the wireless network free of charge.

Parking

9 East 33rd Street (across the street from the conference center):

Can do daily or overnight residential parking first come first serve. The cost is: 1st hour \$4.00, then \$1.00 per hour up to 8 hours which is \$11.00. Anything over 8 hours is \$20.00, which includes parking overnight.

San Martin Garage (about a 15 minute walk) 3350 San Martin Drive, Baltimore:

Cost for this lot is \$10.50 per day. Overnight guests allowed

Metered parking on the streets (33rd Street, St. Paul Streets, North Charles Street)

There is street parking—please read the meters carefully. Some streets have free parking—if you are willing to walk 15 minutes or so look on St. Paul Street or N. Calvert Street between 28th and 33rd Streets. Most charge for 8am – 6pm or 8am – 9pm. You must pay meters during the designated time but it is free outside those hours. Most of these meters are \$.50 per hour, but guests should make sure to read the meter in the area they are parking for confirmation on times and prices.

Transportation to Marc Train/Penn Station and Baltimore's Inner Harbor

A bus line called the Charm City Circulator takes passengers at no cost to the Inner Harbor and to the MARC Train/Penn Station (Monday through Fridays Only 6:00 am - 11:00 am and 2:30 pm - 8:00 pm). There is a stop across the street from the Charles Commons Building. See the schedule at www.charmcitycirculator.com/content/harbor-connector.

Returning to the Airport

See note above about the Charm City Circulator if you are returning to the MARC Train/Penn Station Monday through Friday.

SuperShuttle will be offering a special discount for their shuttle services to and from BWI Thurgood Marshall (BWI), Dulles International (IAD), or Ronald Reagan National (DCA) airports. CCIH conference attendees will receive a 10% discount if they use SuperShuttle or ExecuCar transportation services to any of these airports.

Please use this link to book your reservation and receive the discount: <http://tinyurl.com/ccih2017shuttle>.

Pharmacy and Other Incidentals

■ **Barnes & Noble** (Immediately next door to conference site)

3330 Saint Paul Street, (Charles Commons), Baltimore, MD 21218

■ **Eddie's Market** (One block from conference site)

3117 St. Paul Street, Baltimore, MD 21218 | Tel: 410-889-1558

Food, deli items, toiletries, and medicines. There are many other places you can eat around the conference site also.

■ **FedEx Store** (Two blocks from conference site)

3003 N Charles St Baltimore, MD 21218 | Tel: 410-467-2454

This location is a convenient 5 minute walk from the conference site. We recommend using this site if you need to make high quality copies of printed materials or ship items at the end of the conference. Please note that there is no FedEx pickup on Sundays, so your items will be shipped the following Monday.

Explore graduate leadership programs for the common good.

MS in Nursing

Connect your faith, your nursing profession & your ministry

- ▶ Leadership and management track
- ▶ Online format links you with nurses globally

emu.edu/msn • 540-432-4240

Humanitarian Action Leadership program

Online leadership training for humanitarian, disaster & mission workers

- ▶ Graduate certificate
- ▶ Professional training courses

emu.edu/hal • 540-432-4192



SCHOOL OF GRADUATE & PROFESSIONAL STUDIES

Harrisonburg, Virginia





Thank you CCIH and faith-based organizations for continuing to fight for comprehensive foreign assistance funding.

Your dedicated work to end hunger and thirst is a blessing to all God's Children.

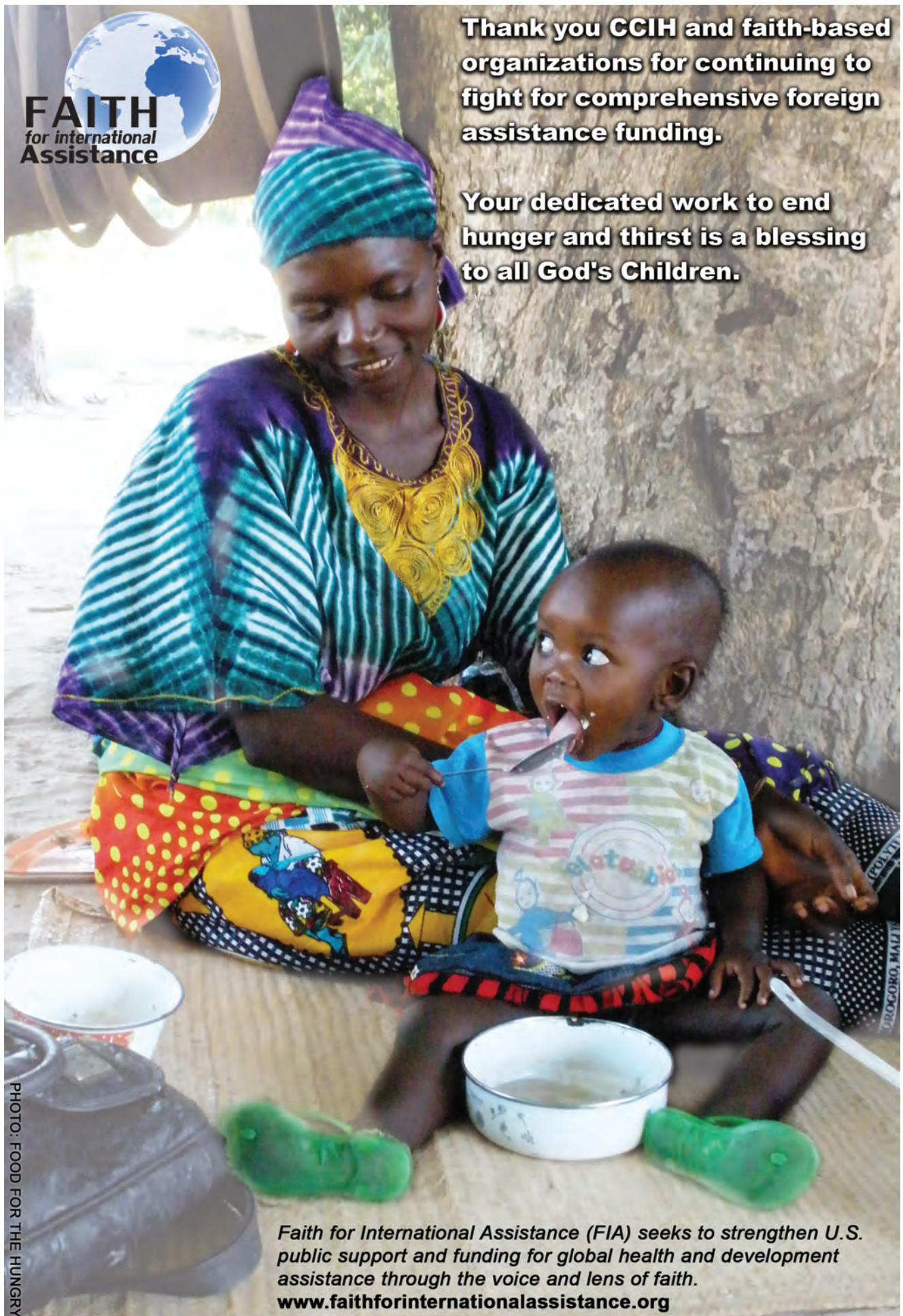

PHOTO: FOOD FOR THE HUNGRY

Faith for International Assistance (FIA) seeks to strengthen U.S. public support and funding for global health and development assistance through the voice and lens of faith.
www.faithforinternationalassistance.org

Nearby Restaurants

BOZ'S Burger Bistro (Fast Food Burger Restaurant) bozsburgerbaltimore.com
3101 St Paul St, Baltimore, MD 21218 (410) 889-1718

Carma's Café carmascafe.com
20 St Paul St #7, Baltimore, MD 21218 (410) 243-5200

Chipotle Mexican Grill (Mexican fast food) chipotle.com
3201 St Paul St, Baltimore, MD 21218 (410) 662-1701

Honeygrow (Salads & Stir-Fry) honeygrow.com
3212 St Paul St, Baltimore, MD 21218 (410) 243-0107

Ledo Pizza (Pizza) locations.ledopizza.com
3201 St Paul St # G, Baltimore, MD 21218 (443) 835-2172

Masala Kitchen (Indian)
3105 St Paul St B, Baltimore, MD 21218 (410) 500-4513

Niwana Restaurant (Japanese) niwanarestaurant.com
3 E 33rd St, Baltimore, MD 21218 (410) 366-4115

The PaperMoon Diner (Diner—casual food) papermoondiner24.com
227 W 29th St, Baltimore, MD 21211 (410) 889-4444

PekoPeko Ramen (Ramen) pekopekoramen.com
7 E 33rd St, Baltimore, MD 21218

Pizza Studio Charles Village (Pizza) pizzastudio.com
3201 St Paul St, Baltimore, MD 21218 (410) 366-1896

Potbelly Sandwich Shop (Fast sandwiches) potbelly.com
3201 St Paul St # G, Baltimore, MD 21218 (443) 451-1106

Subway (Sandwiches fast food) subway.com
3233 St Paul St, Baltimore, MD 21218 (410) 235-0050

Tamber's (American and Indian) tambersrestaurant.com
3327 St Paul St, Baltimore, MD 21218 (410) 243-5777

THB Bagels & Deli of Charles Village (Deli & Bagels fast food) eatthb.com
3208 St Paul St, Baltimore, MD 21218 (410) 624-7152

LIBERTY UNIVERSITY

DEPARTMENT *of* PUBLIC & COMMUNITY HEALTH



PUBLIC HEALTH

B.S. in Public Health

Concentrations in

Health Promotion

Pre-Clinical

Master of Public Health

Concentrations in

Epidemiology, Global Health,

Health Promotion, Nutrition

www.liberty.edu/publichealth | (434) 582-2333

Campus Map

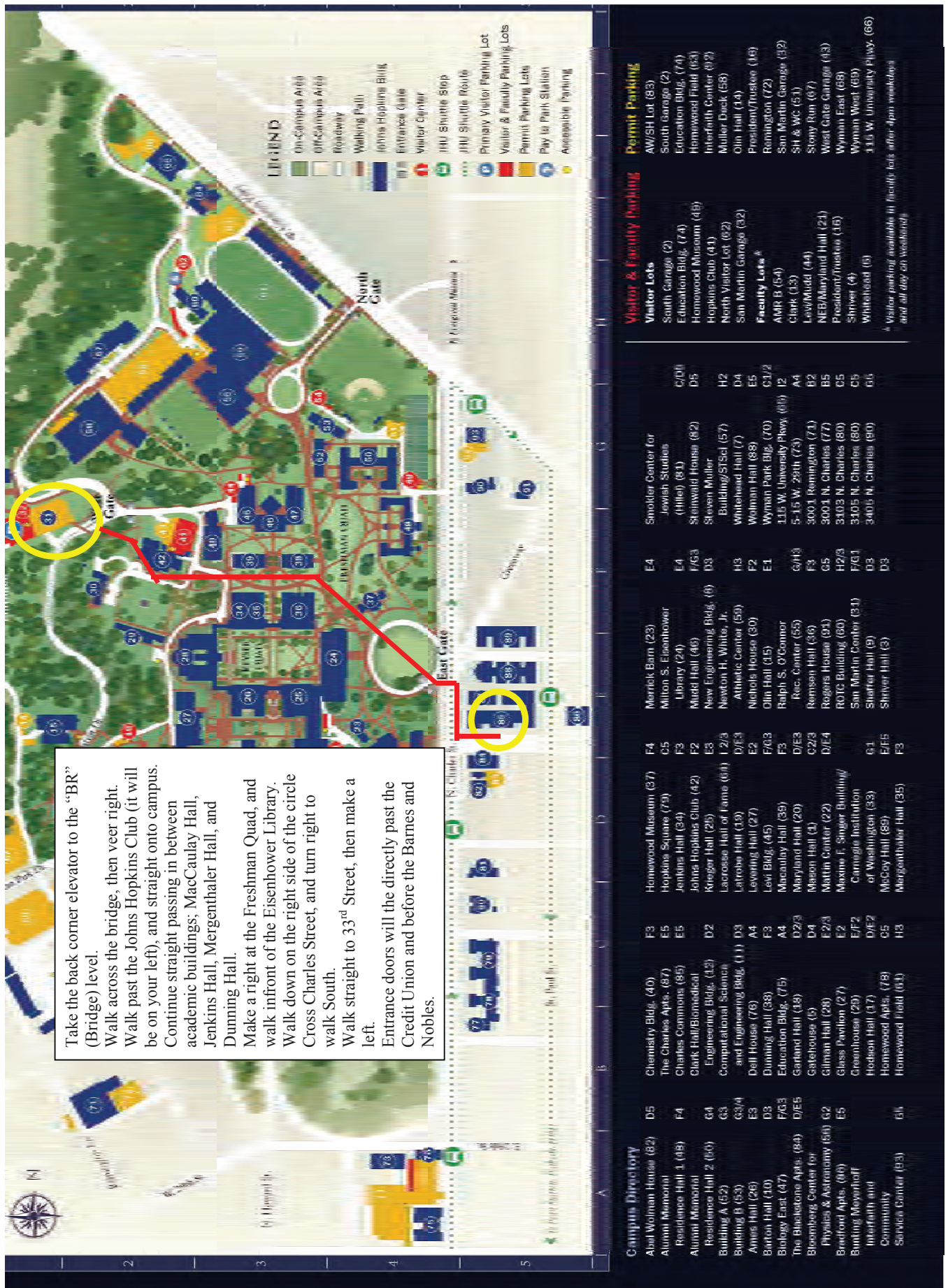

Charles Commons Lodging



DEPARTMENT OF
HOUSING & DINING
SERVICES

Charles Commons
St Paul Building - South - 5th-12th Floors

Map for Sessions in Charles Commons

“L” Level of Charles Commons

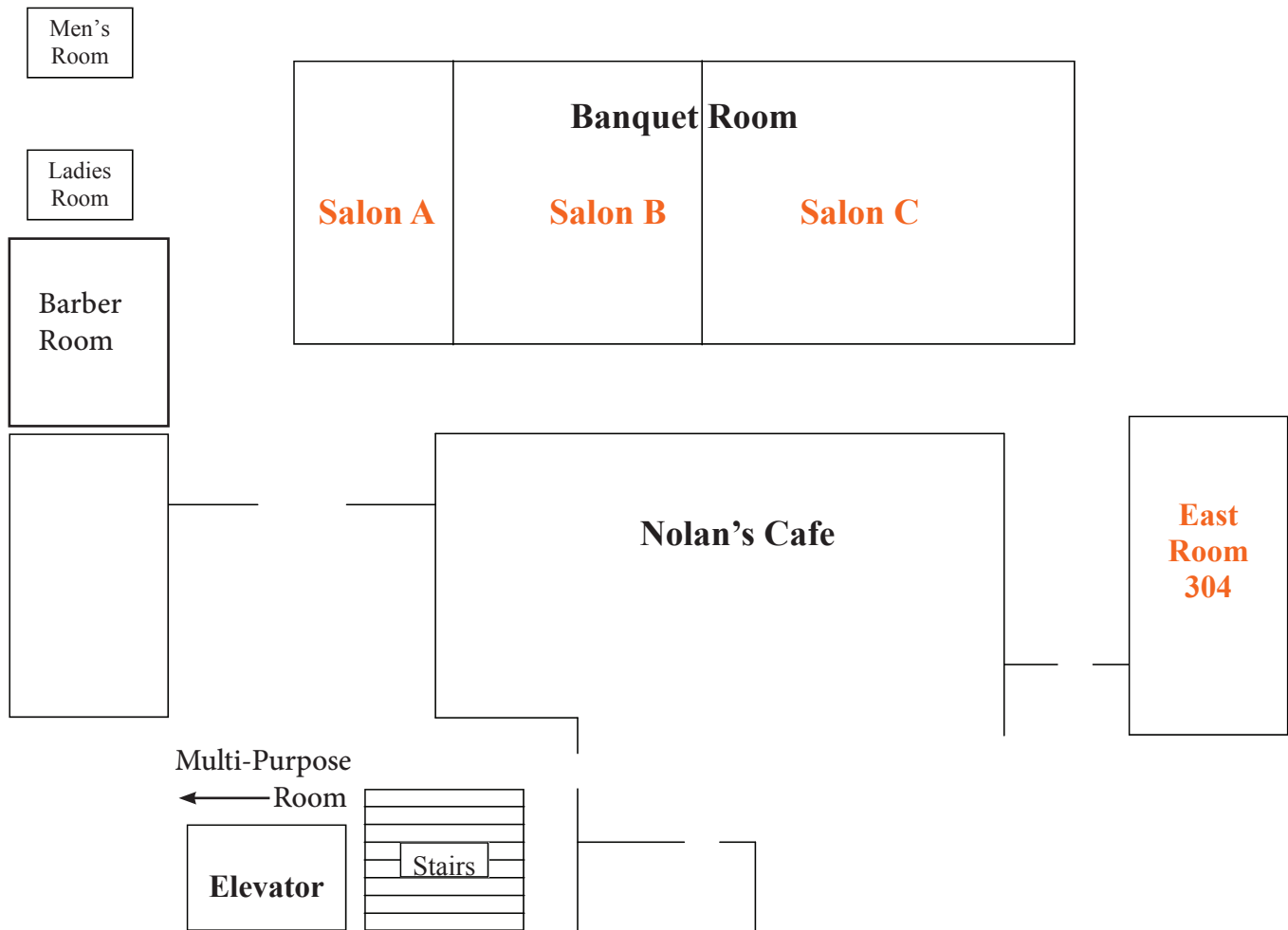

Theme Tables

During mealtimes, attendees will lead roundtable discussions on topics relating to faith-based work in global health. These are fantastic opportunities to address important issues in our work, network and make deeper connections with other attendees. Look in the program for pre-arranged Theme Tables at meal times and for signs in the dining hall.



Guide to Exhibitor/Sponsor Booth Locations

All Gold and Silver Sponsor tables will be located in the main session space, Salons B & C.

Gold

American Association of Pro-Life
Obstetricians and Gynecologists
Americares
Faith for International Assistance
Liberty University Department of
Public & Community Health
Novartis Social Business
Samaritan's Purse

Silver

IMA World Health
IMRES
Loma Linda University
School of Behavioral Health
Salvation Army World Service Office
SANRU
SIM

Bronze Sponsor tables will be located in the following two rooms, Salon A and the Barber Room.

Salon A

Adventist Development and Relief
Agency (ADRA)
Catholic Medical Mission Board
Campbell University School of
Osteopathic Medicine
Cedarville University Master of
Science in Nursing
Christian Journal for Global Health
Christianity Explored
Center for Biblical Equality
eMi
Equip International
International Aid
Mission Nation Travel

Barber Room

CURE International
Eastern Mennonite University
School of Nursing
It's Our Mission: Period!
MAMA Project
Raptim Humanitarian Travel
ROW Foundation
Sawyer Products International
World Hope International

ProLifeOB|GYNS

AAPLOG American Association of Pro-life Obstetricians & Gynecologists

A pregnant woman is shown from the waist up, wearing a light grey cardigan over a white top. She is holding her belly with both hands. The background is a soft-focus outdoor scene with warm, golden light.

Our objective is to reaffirm the unique value and dignity of individual human life from fertilization onward in a culture that continues to devalue human life. In addition, we are extremely concerned about the potential long-term adverse consequences of abortion on a woman's future health. With a goal to be a leading voice on abortion-related health risks, we explore data and medical studies regarding abortion-associated complications, such as depression, substance abuse, suicide, other pregnancy associated mortality, subsequent preterm birth, placenta previa, and breast cancer. Finally, we advocate on behalf of pro-life physicians to successfully and continually defend the physician's right of conscience to make life-preserving decisions.

To achieve these goals, we publish peer-reviewed articles in professional journals, submit amicus filings with state and federal courts and defend pro-life positions as medical expert witnesses, sponsor the annual Matthew Bulfin Educational Conference, offer Continuing Medical Education (CME) modules, distribute informative brochures to physicians and their patients on adverse health outcomes related to abortion, provide guidance to physicians around the world, and mentor pro-life medical students, OB/GYN residents and other health professionals in training. Come join us!

Life...
it's why we're here.

CONFERENCE SCHEDULE DAY 1

7:30am to 8:30am

Breakfast
Nolan's Dining Hall

Conference Registration from 8:00 am to 7:00 pm. Housing Check-In from 2:00 to 4:00 pm

8:00am to 1:00pm

Morning Pre-Conference: Do We, The Church, Engage and Reach Youth?
Salons B & C

(Additional charge applies. Simple breakfast and box lunch provided.)

Nearly 50% of the world's population is younger than 30, the majority of which live in developing countries. Our youth face incomplete education, early marriage, early childbearing, threat of HIV, violence and conflict. Join us to discuss how faith-based organizations are reaching youth on the issues of HIV, family planning, body literacy, and in areas of conflict. We will address questions such as: How does The Church reach youth to help them flourish and thrive? What are the best practices of faith communities on reaching youth? Can we share what has *not* worked? And what can we share and learn so we can strengthen our programs?

Schedule for Pre-conference Session:

8:00 to 8:45am Breakfast and Personal Stories from Two Youth Participants:

Ngalande Ngalande, Jr., LLB, Advocacy Officer, Churches Health Association of Zambia and Eloho Basikoro, PhD, Intern, World Vision

8:45 to 9:00am Introductions and Welcome

9:00 to 9:15am Statistics and Definitions: Jeff Jordan, President & CEO, Population Reference Bureau

9:15 to 9:40am What's Working and What's Not Working? Cate Lane, USAID

9:40 to 11:10am Roundtables focused on 5 Topics:

- Youth & HIV (Gloria Ekpo, World Vision and Claudia Llanten, Catholic Medical Mission Board)
- Youth & Reproductive Health Education for Youth (Lauren Van Enk, Institute for Reproductive Health)
- Youth & Family Planning (Marta Pirzadeh, FHI 360 and Ngalande Ngalande, Churches Health Association of Zambia)
- Youth in Humanitarian Settings (Rachel Moynihan, UNFPA)
- Youth & Child Marriage (Rachel Clement, International Center for Research on Women, co-chair of Girls Not Brides)

11:10 am to Noon: Action Steps/Commitments/Summary

Noon to 1:00 pm: Lunch and Networking

Planned by the Health of Women & Children sub-group, including representatives from: Advancing Partners and Communities (APC), Catholic Medical Mission Board, CCIH, Churches Health Association of Zambia, Ecumenical Pharmaceutical Network, Institute for Reproductive Health, Uganda Protestant Medical Bureau, World Relief, and World Vision.

Thanks to Advancing Partners & Communities and the United Nations Foundation Universal Access Project for sponsoring the pre-conference.

12:00pm to 1:00pm Lunch
Nolan's Dining Hall

1:15pm to 4:00pm Monitoring & Evaluation Pre-Conference
Multi-Purpose Room
(Additional charge applies.)

We will explore concepts and principles of designing monitoring and evaluation (M&E) frameworks, learning from good and bad examples, and experience a hands-on lab session working in teams.

Speakers:

- Anbrasi Edward, PhD, MPH, MBA, MSc, Associate Scientist, Johns Hopkins University Bloomberg School of Public Health
- Jennifer Winestock Luna, MPH, Director of M&E Services, Realizing Global Health

4:00pm to 5:00pm Break/Dinner On Your Own

5:00pm to 7:00 pm Opening Plenary & Worship: Salons B & C

Worship led by Stephen Stake (MHS, DrPH—Johns Hopkins Bloomberg School of Public Health), Jami Cheng (MSPH, Johns Hopkins Bloomberg School of Public Health), Laura Mobula, (BS in Electrical Engineering, University of Toledo, Ohio), and Deborah Mobula (BS in Civil Engineering, University of Toledo, Ohio).



SAWYER
INTERNATIONAL

Your Choice of Filters.



A Variety of Delivery Systems.



Sawyer is the Worldwide Leader in Water Filtration.
Whatever works best for you, Sawyer has it.
Gregg Keen, gregg@sawyer.com

Daily Devotion 1—Opening Plenary Session

Our Source of Strength

Halfway through the shallow river, you know it was a mistake. Your spinning wheels make no progress; your tires sink deeper into the mud. You are miles from anywhere, no cell phone service. You whisper a prayer, “help me Jesus.” Before long, there are no less than 20 people, rocking your car free and pushing it to the other side. They give out a cheer as you head to the main road.

Too often, we face our problems alone, without asking God for help. “Here, I am! I stand at the door and knock,” says the King of Kings in Revelations 3:20. Instead of inviting him in, we trust in our own strength, our own resources; we are too busy, too resourceful to ask for help. Or, we are too proud to seek and receive help from one another.

As followers of Christ, our strength is not our own, it does not come from wealth or position in the world, but in our having a vibrant, dynamic relationship with Jesus. “I can do all this through him who gives me strength,” Paul writes in Philippians 4. Paul was confident that God is the only source that gives us the strength to overcome the trials, temptations and perils we face in our life and work. Through total trust and submission, Paul was able to be strong in the Lord and in the power of His might and fully armed to stand against the wiles of the devil. (Ephesians 6:10-11)

"Do not be anxious about anything, but in every situation, by prayer and petition, with thanksgiving, present your requests to God." Philippians 4:6.

- 1) What prevents you from asking God for help in your day-to-day activities?
- 2) To what extent are you in conversation with God about the life and work he has given you?
- 3) How has God come to your rescue by sending others to help you?

NOTES

Conference Kick Off: Bob Blee, Interim Executive Director, CCIH

Welcome Messages From Gold Sponsors

Americares: Julie Varughese, MD, Medical Officer

Faith for International Assistance: Shepherd Smith, President of the Institute for Youth Development and Faith for International Assistance Capitol Hill Liaison for Global Health



Session: The Role of Faith-based Organizations in Health Systems Strengthening

Faith-based organizations provide a significant amount of the health care in many developing nations, especially in areas where people lack access to care from government and other providers. These FBOs are forging partnerships and capitalizing on new technology to deliver care and strengthen the health systems in which they operate. We will learn how FBOs are making an impact in the diverse and changing environments where they operate, including:

- Country-specific examples from Cameroon to Haiti where the role FBOs play in Health Systems Strengthening differs dramatically due to a number of factors, such as how they interact with the Ministry of Health and how health systems are designed.
- An exciting initiative by The Conrad N. Hilton Foundation and Catholic Medical Mission Board to build capacity and innovation through technology, including eHealth/mHealth, resulting in strengthened care delivered by a group of Catholic hospitals.
- How Christian health providers in Ghana have had remarkable success partnering with the Ministry of Health to meet the needs of the people of Ghana.



Katie Taylor



Frank Baer



Paul Mikov



Peter Yeboah

Moderator: Katie Taylor, MA, International Executive and Development Leader, *Former USAID Assistant Administrator for Global Health*

Speakers:

- Frank Baer, MHS-TM, DrPH, Vice-President, SANRU: *Thinking Inside the Box: Paradigms for Health Systems Strengthening with FBOs*
- Paul Mikov, MA, Vice President of Institutional Partnerships, Catholic Medical Mission Board: *eHealth/mHealth in Faith-Based Health Systems and Programs*
- Peter Yeboah, MPH, MSc, Executive Director, Christian Health Association of Ghana and Chair of the Africa Christian Health Associations Platform: *Partnerships Among MOH and FBOs in Ghana*

7:00 pm to 9:00 pm

Welcome Reception and Time to Network and Visit with Exhibitors
Salon A, Salons B & C, and the Barber Room

Thanks to our Reception Sponsors the Christian Journal for Global Health and World Vision



NOTES



Health within reach

Americares saves lives and improves health
for people affected by poverty or disaster
so they can reach their full potential.

Learn more about our work at americares.org



Health Is On The Way is a trademark of Tandigm Health, LLC



FRIDAY, JULY 14

CONFERENCE SCHEDULE DAY 2

Conference Registration from 7:00 am to 4:00 pm. Housing Check-In from 7:00 am to Midnight

7:00 am to 8:30 am **Breakfast**
Nolan's Dining Hall

8:30 am to 9:15 am **Morning Prayer and Praise**
Salons B & C

Worship led by Stephen Stake (MHS, DrPH—Johns Hopkins Bloomberg School of Public Health), Jami Cheng (MSPH, Johns Hopkins Bloomberg School of Public Health), Laura Mobula, (BS in Electrical Engineering, University of Toledo, Ohio), and Deborah Mobula (BS in Civil Engineering, University of Toledo, Ohio)

9:15am to 10:35am **Plenary Session 2: Salons B & C**

Welcome Message from Gold Sponsor

Liberty University Department of Public and Community Health: Jonathan Giles, MPH, Assistant Dean

Churches: A Unique Force for Community-Based Primary Care

Communities that are empowered, educated on matters of health and driven by Christian values to care for each other are uniquely positioned to improve the health of community members. We will learn how three programs have resulted in real progress in health thanks to involvement of church partners and Christian community health workers, including:

- World Relief's program to work with church partners in Malawi to provide social support and encourage healthy behaviors among 1,500 HIV-positive individuals.
- World Renew's program in Bangladesh in two areas with high maternal and child mortality to engage unpaid village-level community health workers to dramatically increase uptake of health services, incorporating Biblical values into their training.
- A program by the Anglican Diocese of Niassa in Mozambique that resulted in tremendous increases in health knowledge and healthy practices in communities after more than 10,000 volunteers developed their God-given gifts and now live as active agents of change in 321 rural villages.



Laura van Vuuren



Amberle Brown



Grace Kreulen



Rebecca Vander Meulen

Moderator: Laura van Vuuren, Global Health Consultant

Speakers:

- Amberle Brown, RN, MSN, MPH, Program Advisor, Health and Nutrition, World Relief: *Mobilizing the Church to Support People Living with HIV in Malawi: A Qualitative Assessment of World Relief's HIV Support Groups*
- Grace Kreulen, PhD, Health Program Consultant, World Renew: *Unpaid CHWs: An effective sustainable approach to selection, training, and support of unpaid MNCH community health volunteers*
- Rebecca Vander Meulen, MPH, Director of Community Health and Development (Mission), Anglican Diocese of Niassa—Mozambique: *From Beneficiaries to Agents: Community Activists in the Mozambican Diocese of Niassa*

10:35 am to 11:00 am**Refreshments and Visit with Exhibitors
Salon A, Salons B & C, and the Barber Room****11:00 am to 12:00 pm****Breakout Sessions 1: Three Sessions Running Concurrently*****Session A: Christians Respond to Violence, Stigma and Lack of Care for Women | Salons B & C***

The Bible tells us that men and women are both created in the image of God; yet, women suffer widespread sexual violence and stigmatization related to menstruation, and struggle to receive care during childbirth. We will learn how Christian organizations in three locations are rising to the challenges of these injustices:

- Samaritan's Purse engages the local church in the Democratic Republic of the Congo to address the massive number of rapes, an estimated 1,150 every day.
- Stigmatization and lack of supplies for menstruation cause women and girls to miss school and employment opportunities. It's Our Mission: Period! presents an evangelistic model of how God loves women and provides sensible solutions for women in disadvantaged areas.
- In a remote community in Niger with a population of 11,000, only one hospital bed was allocated for women to deliver. Samaritan's Purse developed an innovative approach to involve community leaders and men to build a dedicated ward for deliveries.

Moderator: Amy Hewitt, Grant Writer and Manager of Lab-In-Suitcase Program

Speakers:

- Emma Smith Cain, MA, Samaritan's Purse: *A Lasting Change: Addressing Gender-Based Violence through Church-Based Interventions and Protection Committees*
- Donna Terpstra, Executive Director, It's Our Mission, Period!: *She's Worth It!*
- Bruce Larkin, MPH, Health & Nutrition Program Manager, Samaritan's Purse Niger: *Promoting Birth Spacing in an Islamic Context*

Session B: Reports from the Field: Health Systems Strengthening & FBOs | East Room

Faith-based organizations are involved in many aspects impacting overall health systems, from large-scale medicine procurement projects to helping marginalized communities have access to care, basic services and clean water. We will hear about three efforts to improve the delivery of care:

- Access to quality-assured medicines remains a major challenge in most low- and middle-income countries. The Ecumenical Pharmaceutical Network is working with four faith-based drug supply organizations in Kenya, Tanzania, Rwanda and Uganda on a Pooled Procurement Project to ensure access, affordability and availability to lifesaving medicines.
- In an interactive presentation, we will discuss feedback from CCIH members on healthcare delivery to help us understand how we can strengthen our work and meet the objectives outlined in the CCIH Strategic Plan to "strengthen the role of members to improve fragile local and national health systems."
- Neglected Tropical Diseases (NTD) affect many marginalized and voiceless communities. We will explore initiatives in health promotion and empowerment to address NTDs and help people flourish where there is poor housing, sanitation, unsafe water and limited access to basic health services.

(Continued on page 26)

Daily Devotion—Plenary Session 2

An Uncomfortable Truth

Not far from here, at the Baltimore Museum of Art Sculpture Garden, you will find two cast figures expressing uncomfortable truth for today's youth.

John the Baptist—his face shouting anger and agony, his body open and distorted, his arm and fist raised in declaration—is cast as a powerful force by Pablo Gargallo with the title, *The Prophet*.

His message echoes the Prophet Isaiah in the Scriptures—"A voice crying in the wilderness, prepare the way of the Lord, make his paths straight." Matthew 3:3.

His mother, Elizabeth, a few steps away in the sculpture garden, is displayed by Jacob Epstein as pregnant beyond her years, pensive with neck bowed and arms extended in submission. The Scriptures say that when Elizabeth was visited by Mary, "the baby in my womb leaped for joy. And blessed is she who believed that there would be a fulfillment of what was spoken to her from the Lord." Luke 1:44-45.

From fetal position to early adulthood, John the Baptist was on the move, defying the normalcy of his peers and drawing attention to the One whose straight path he would follow with a clear call to repentance. Many came with expectations and questions. The Spirit of God descended on the Well-Pleased One he held in his embrace, visualizing and declaring the Triune God.

As in every generation, today's youth have questions and expectations and are eager for meaningful relationships. May we embrace the truth of the Triune God and work together to make straight the path before them with John's clear declaration and his mother's submission.

- 1) What barriers keep us from walking a straight path?
- 2) What does repentance and submission look like in your life?
- 3) How can we build relationships, especially with youth, that reflect the unity and obedience of Christ?

NOTES

Novartis Social Business
Malaria Initiative



Together we can end malaria for good

The fight against malaria continues to advance, led by the hard work of countless people like nurse Agnes Akoth, who regularly visits schools in southwestern Kenya to help children better understand how to minimize the risks they face. Since 2001, working with a range of organizations and people on the ground like Agnes, we have provided more than 800 million antimalarial treatments without profit to endemic countries.

We look forward to meeting you. Please join Session 4B at 2pm on Saturday July 15 or stop at our table during the CCIH meeting.

Find out more about our malaria program and our work to increase access to medicines against chronic diseases:

www.malaria.novartis.com

www.novartisaccess.com



S-NSZ-1346327: 06/2017

Moderator: Theresa Nyamupachitu, MSc, Senior Program Advisor, Health Systems Strengthening, IMA World Health

Speakers:

- Mirfin Mpundu, PharmD, MPH, MBA, Executive Director, Ecumenical Pharmaceutical Network: *Addressing Access Challenges To Medicines Through Pooled Procurement—An Example Of East African Faith-based Drug Supply Organizations*
- Wendy Jolley-Kabi, MPA, President & CEO, Global Health Action: *Best Practices in Healthcare Delivery: An Interactive Dialogue*
- Linda Lehman, MPH, Technical Director of Programs, American Leprosy Missions: *Integrating Care across Neglected Tropical Diseases and Chronic Health Conditions*

Session C: Standing on Holy Ground: The Spirituality of Care | Multi-Purpose Room

Moderator Dr. Daniel O'Neill of the Christian Journal for Global Health will lead this discussion on integrating faith with health care. He will explore Ignacian practices of recognizing God's presence in all things, listening, mindfulness, reflection and entering the story of the patient, culture and community and connecting these stories to God's meta-narrative. Speakers from Eastern Mennonite University's Nursing Department will discuss EMU's integration of Spirituality and Care and how the school has adopted O'Brien's sacred covenant philosophy to shape their approach to nursing care, education, and personal relationships. This philosophy is based on Moses' story at the burning bush: standing on holy ground.

Moderator: Daniel O'Neill, MD, MA(Th), Managing Editor, Christian Journal for Global Health

Speakers:

- Don Tyson, PhD, Professor of Nursing, Eastern Mennonite University
- Ann Hershberger, PhD, Professor of Nursing, Eastern Mennonite University

WE HELP PEOPLE

Imres is a leading global supplier of high quality and affordably priced pharmaceuticals, medical consumables, hospital equipment and medical kits.

We are a USAID approved wholesale organization and we exclusively focus on delivering humanitarian assistance to developing countries by partnering with US and international NGOs, FBOs, Ministries of Health, WHO, UN, Red Cross societies, charities and other relief agencies.



Customized Kits



Affordable Pharmaceuticals



One-Stop-Shop

MEDICAL SOLUTIONS WITH A GLOBAL IMPACT

Please contact us for more information:

Jarno de Lange Phone (780) 289 8817 Email delange@imres.nl	Erwin van Boven Phone +31 (320) 29 6969 Email vanboven@imres.nl	www.imres.nl Larserpoortweg 26 8218 NK Lelystad, Netherlands
---	--	---



12:00pm to 1:00pm Lunch: Nolan's Dining Hall

Thanks to the Eleanor Crook Foundation for providing support for lunch

Theme Tables

Emerging Standards for Volunteers and Product Donations in Humanitarian Emergencies, led by Doug Fountain, Vice President for Strategy and Impact, Medical Teams International

Holistic Needs of Children in Crisis: Crisis Care Training International will lead a discussion on resources available to help you and your organization address the holistic needs of children in crisis.

Short-term Medical Missions: Are We Really Helping? led by Julie Varughese, MD, Medical Officer, AmeriCares

1:00pm to 1:30pm Visit with Exhibitors
Salon A, Salons B & C and the Barber Room

1:30pm to 2:30pm Breakout Sessions 2: Three Sessions Running Concurrently

Session A: Advocacy, Empowering Faith Groups & Managing Imperfect Testing in HIV | Salons B & C

Faith groups have many important roles in addressing HIV/AIDS. They have influence with religious leaders and are able to engage them in educational efforts; FBOs serve as advocates working for greater government support of health costs for those affected by HIV/AIDS; and they are well-positioned to address stigma and encourage HIV testing. We will hear from three faith groups about their work in HIV/AIDS:



WORLD SERVICE OFFICE

EMPOWERING COMMUNITIES

The Salvation Army World Service Office supports health programs throughout the world, partnering with other non-profits to provide comprehensive health care and ensure accessibility for families and communities in need. Visit sawso.org to learn how you can help.

ANTI-HUMAN TRAFFICKING LIVELIHOODS DISASTER RELIEF COMMUNITY HEALTH

615 Slaters Lane P.O. Box 1428 • Alexandria, VA 22314 • sawso@usn.salvationarmy.org • 703 684 5500

- IMA World Health is partnering with the Christian Health Association of Kenya to engage religious leaders in the slum areas of Korogocho, Nairobi to expand demand and uptake of pediatric HIV services.
- The Churches Health Association of Zambia (CHAZ) has a robust advocacy program, resulting in agreements with the Ministry of Health committing the Government to provide grants covering 75 percent of operational costs for Church Health Institutions, including work in HIV/AIDS.
- False positives in HIV testing present a number of challenges. An SIM hospital in Niger provides HIV testing and must address the challenge of maintaining the trust of the majority Muslim population it serves and avoid stigma for those with HIV.

Moderator: Chad Hayward, Executive Director, Accord Network

Speakers:

- Nkatha Njeru, MPH, Africa Christian Health Associations Platform (ACHAP) Coordinator, IMA World Health/ACHAP: *Faith on the Fast Track for Pediatric HIV*
- Ngalande Ngalande, Jr., LLB, Advocacy Officer, Churches Health Association of Zambia: *CHAZ Health Advocacy*
- Matthew Megill, MD, Director of HIV and TB Programs, SIM Galmi Hospital Niger: *Imperfect HIV Screening Tests: An Implicit Moral Accusation?*

Session B: Family Planning in Uganda & Senegal with Catholics & Protestants | East Room

FBOs are making great strides in Africa in family planning. Three organizations will share results and experiences from Uganda and Senegal to evaluate the work of faith groups in family planning, partner with a consortium to launch an advocacy campaign, and engage religious leaders to promote family planning:

SANRU acknowledges our current donors:



SANRU has been a major partner with the Ministry of Health in DR Congo for sustainable health systems development since 1981.

SANRU currently provides targeted and global health assistance to more than 400 of DRC's 516 Health Zone with a particular focus on HIV and Malaria.

SANRU fully supports the 2030 Agenda for Sustainable Development.

SANRU extends a warm invitation to other partners to join us in rebuilding and sustaining DR Congo's decentralized Health System so that more people in need will have access to improved health care services and so that we can achieve **SANRU's goal of "Health for All and by All."**











Global Fund
for Malaria and HIV

GAVI
for vaccination via Civil Society Organizations

The World Bank
for strengthening of National Health Information System (SNIS/DHIS2)

DFID
for global support for primary health care

CDC / PEPFAR
to alleviate the burden of HIV

Packard Foundation and Bill and Melinda Gates Foundation
are donors for ACQUAL Project (family planning) via Tulane University



365 repair vesicovaginal fistulas with over 90% success



The Director GAVI helps kickoff an immunization campaign



Identification of suspect cases of TB in an urban prison of Tshikapa



Before After
Rehabilitation of the Health Center of TSHIMPUTU

SANRU: "Health for All and by All"

- Analysis of the results of a study on quality and outcomes of FBO work in family planning conducted by the Institute for Reproductive Health at Georgetown University in collaboration with the Uganda Protestant Medical Bureau and Uganda Catholic Medical Bureau.
- The Faith To Action Network partnered with the Uganda Family Planning Consortium to implement a Faith+Family Planning Advocacy Initiative through six FBOs in Uganda, resulting in 50 religious leaders being trained as FP Champions and replication of the program in a number of other countries.
- An impactful program in Senegal by the World Faiths Development Dialogue to reduce maternal mortality through family planning engages senior-level religious leaders at the national and local level and connect with women's religious networks.

Moderator: Douglas Huber, MD, MSc, Co-Chair, Family Planning/Reproductive Health Committee, CCIH

Speakers:

- Lauren Van Enk, MPH, Program Officer, Institute for Reproductive Health at Georgetown University: *Does it measure up? Assessing the quality of family planning counseling through faith-based health facilities*
- Jackie Katana, MPA, International Advocacy Officer, Faith to Action Network: *Enhancing sub-national Family Planning +Faith advocacy initiative through faith-based approach*
- Lauren Herzog, MA, Program Coordinator, World Faiths Development Dialogue and Wilma Mui, MPH, Program Associate, World Faiths Development Dialogue: *Engaging Women's Religious Networks on Family Planning*

There are people
living and dying
without Jesus.

Do you want to see this change? We do.

From its earliest years, SIM has cared for and about those who live and die without hearing God's good news, compelling us into communities where He is least known. Over a century later our heart remains the same, now with around 4,000 multiskilled workers from 65 countries. Serving together on six continents, we pursue hard places through prayer and care as we respond to need, proclaim the gospel, and equip the Church.

SIM

Pray

Give

Go

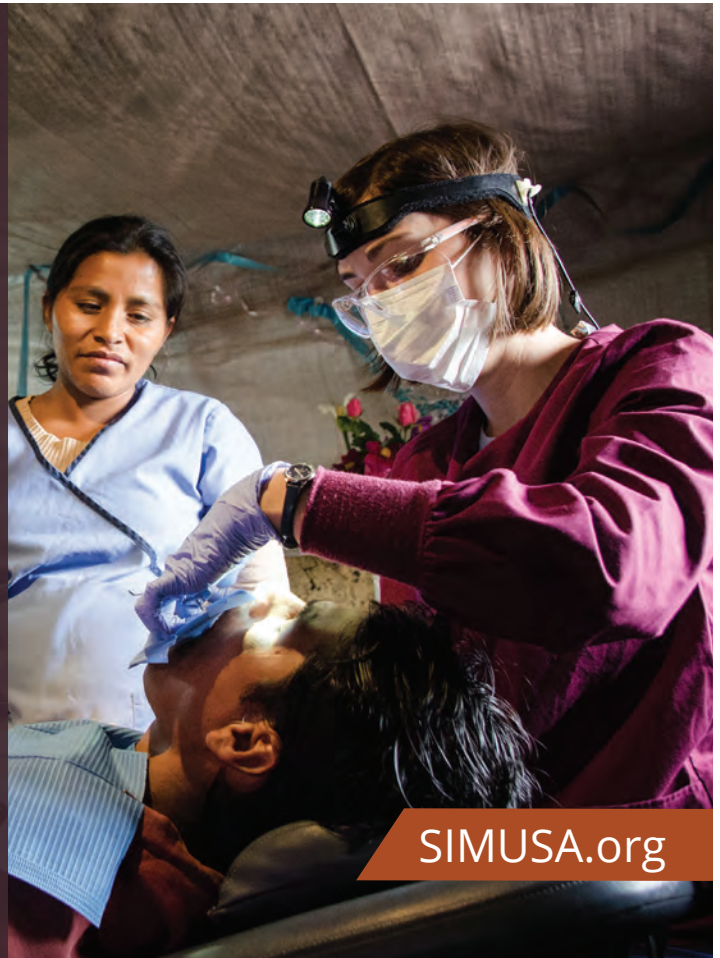

SIMUSA.org

Session C: Faith Groups Reaching the Last Mile with Care | Multi-Purpose Room

A well-known strength of the faith community is its ability to reach the “last mile” or the child “at the end of the road.” We will explore results of the work of three faith-based organizations with vulnerable and hard-to-reach populations:

- The United Methodist Church’s Abundant Health Initiative—a plan to reach 1,000,000 children under 5, with low cost, life-saving interventions, in hard-to-reach areas.
- The Community Outreach Initiative works in rural Mozambique with religious and community leaders to prevent the spread of HIV/AIDS, provide quality care for people living with HIV, share health messages and discourage harmful cultural practices, such as widow cleansing.
- World Relief began its first project with the Child Survival and Health Grants Program through USAID in 1987 and has learned significant lessons working at the community level about grassroots engagement, volunteerism, and working with religious leaders.

Moderator: Nancy Pendarvis Harris, MPH, Vice President of John Snow Research & Training Institute, Inc.

Speakers:

- Kathy Griffith, Global Health Unit, United Methodist Committee on Relief (UMCOR), General Board of Global Ministries: *At the End of the Road*
- Perpetua Alfazema, Executive Director, Kuwangisana, Community Outreach Initiative: *Strengthening Lives*
- Allison Flynn, MPH, Health & Nutrition Program Advisor, World Relief: *25 years of Child Survival: Lessons Learned*

2:30pm to 2:45pm

Refreshments and Visit with Exhibitors
Salon A, Salons B & C, and the Barber Room



If you enjoy working with others and have a passion for healthcare, the School of Behavioral Health at Loma Linda University can offer you:

- Professionally accredited graduate degrees in Child Life, Counseling, Marital and Family Therapy, Psychology, and Social Work.
- Innovation in evidence-based clinical practice and research.
- Private Christian health sciences center emphasizing whole person care.
- Opportunities to learn as a member of an interdisciplinary treatment team in a world-renowned healthcare setting.
- A diverse faculty, dedicated to ensuring student success.
- Individualized academic and professional mentoring.
- Centrally located near beaches, deserts, and mountains in Southern California.

Please inquire about our dual degree options!

For more information, call us at **909-558-8722** or visit **sbh.llu.edu**.

**MANY STRENGTHS.
ONE MISSION.**



**LOMA LINDA
UNIVERSITY**

School of
Behavioral Health

2:45pm to 4:10pm

Plenary Session 3: Salons B & C

Welcome Message from Gold Sponsor**Samaritan's Purse:** Lance Plyler, MD, Medical Advisor for Disaster Response and Programs***How the Church Can Reach Youth When They Need Us***

How can the church reach the millions of young people across the globe looking for guidance as they navigate the difficult years of adolescence and young adulthood? The Church is a force for positive change, but if we don't reach young people when they need good role models and wise counsel we are missing an enormous opportunity. We will hear from a panel of young professionals from a variety of backgrounds sharing their perspective on how to best reach the youth of today.



Debbie Dortzbach



Jerilyn Cox



Nana Apenem Dagadu



Rhona Murungi



Samuel Shanju

Moderator: Debbie Dortzbach, MPH, MN, Director of Health Social Development, World Relief**Speakers:**

- Jerilyn Cox, BSN, RN, Nurse Care Manager, Whitman-Walker Health
- Nana Apenem Dagadu, MPH, Senior Research Officer, Institute for Reproductive Health at Georgetown University
- Rhona Murungi, MA, Program Officer for Burundi, Kenya, Rwanda and Haiti, World Relief
- Samuel Shanju, HSM, Program Assistant, Ecumenical Pharmaceutical Network

4:10pm to 4:30pm

Group Photo

4:30pm to 5:30pm

Annual CCIH Business Meeting: Salons B & C

Annual Business meeting for CCIH members and affiliates.

5:30pm to 6:30pm

Working Groups Meet (Session I) | Salons B & C

The four working groups addressing CCIH's four focus areas will meet to discuss plans for activities related to their areas.

- Integration of Faith and Health
- Health Systems Strengthening
- Community-based Prevention and Care
- Health of Women and Children

Dinner On Your Own



Photo credit: Lovell Fairchild Communications

8:00 pm Screening of Facing Darkness Movie: The true extraordinary story of saving Dr. Kent Brantly and other medical missionaries during the Ebola outbreak. Salons B & C (Conference Attendees Only)



Tanzania, Photo by Paul Jeffrey/IMA World Health

HEALTH, HEALING AND WELL-BEING FOR ALL. IT'S A JUST CAUSE.

We work in some of the world's most vulnerable communities. Places where preventable disease and a lack of access to care disproportionately affect people simply because they are poor.

Freeing someone from a disease or providing basic care doesn't start with building a clinic, or handing out medicines. It starts with you.

When you care enough to make sure health, healing and well-being are within reach for all God's children, you are part of IMA World Health's vision for a better world. Will you join us?



202-888-6200 | imaworldhealth.org

NOTES

SATURDAY, JULY 15

CONFERENCE SCHEDULE DAY 3

Conference Registration from 8:00 am to Final Plenary. Housing Checkout from 8:00 to 10:00 am
1st Floor North Charles Street Entrance

Please Note: Consider checking out after eating breakfast and before worship starts.

7:00am to 8:30am

Breakfast
Nolan's Dining Hall

Theme Tables

Discernment & Communication: What Works and What Persuades. Engaging in global health work that is effective, just and God-honoring is a challenge. The spoken and written word are powerful ways to communicate truth and beauty, and can multiply these ends. We will discuss ideas about discernment, communication and publication which magnifies ones voice. Led by Daniel O'Neill, MD, MA(Th), Managing Editor of the Christian Journal for Global Health

FBO Engagement in Southeast Asia. We will discuss the role of faith-based organizations in health and healing in Southeast Asia, arranged by Katelyn Long, MSPH and DrPH Candidate, Boston University School of Public Health



- Dedicated to providing comprehensive international travel solutions for faith-based, humanitarian, group, and international adoption travel.
- 265 combined years of humanitarian travel expertise, industry relationships, and specialized airfares.
- Commitment to personable and long-term caring client relations.

PASSION FOR THE WORLD



24/7 AFTER HOURS EMERGENCY SERVICE AVAILABLE BY OUR TRAVEL EXPERTS

WWW.MISSIONNATION.COM

Phone: 954.947.2306

Email: Info@MissionNation.com

Daily Devotion—Plenary Session 4

What happened to God?

This question, posed by a Turkana woman in northern Kenya, haunts me. “It is not raining. We are starving. Our goats and children are dying. We are hungry. Only God makes it rain. What happened to him?”

I looked at her again. Beneath the bold colorful burst of beads, I saw a slender, sinewy, neck and rib-popping chest resembling the washboard roads we just traveled. My answers to her felt weak. “God is here. He knows your need.” She looked at the big white car parked nearby. Was God inside? Surely I could motion him to help.

There are times in our lives when God is silent, and we wonder where he went. In Mark 4:35-41 he was sleeping on a cushion as the panicking disciples screamed above the raging sea, “Teacher, do you not care that we are perishing?”

God asleep, while we die.
Yes. Asleep while awake.

It is a confounding truth. The disciples did not know what God was doing as the waves broke over their boat in the dead of night. But the Scriptures say, Jesus awoke, rebuked the wind, and said to the sea, “Peace, be still.” And to the disciples, “Why are you afraid, have you no faith?” Another day, Jesus slept again—this time on a slab of stone after a brutal death.

And again he rose, stood among them and said, “Peace to you. Why are you troubled? Why do doubts arise in your heart? Thus it is written, that the Christ should suffer and on the third day rise from the dead and that repentance and forgiveness of sins should be proclaimed in his name to all the nations...” (Luke 24:36-47)

What happened to God? He slept, so I can be awake forever and give his healing and hope to the nations.

- 1) In what ways does God appear to be sleeping in your life and ministry?**
- 2) What application does, “Peace, be still.” (Mark 4:39) have to you?**
- 3) How will you respond to those around you who may question, “What happened to God?”**

NOTES

9:00am to 11:00am

Worship and Plenary 4: Salons B & C

Worship led by Stephen Stake (MHS, DrPH—Johns Hopkins Bloomberg School of Public Health), Jami Cheng (MSPH, Johns Hopkins Bloomberg School of Public Health), Laura Mobula, (BS in Electrical Engineering, University of Toledo, Ohio), and Deborah Mobula (BS in Civil Engineering, University of Toledo, Ohio)

Welcome Message from Gold Sponsor

Novartis Social Business: Nathan Mulure, MD, MPH, MPharm, Cluster Head for Novartis Social Business in East and Southern Africa

Faith Journey of Ebola Doctor Kent Brantly

Compassion over fear is how Dr. Kent Brantly describes the most important lesson he learned from his experience treating Ebola patients in Liberia and ultimately becoming infected with the virus in the 2014 outbreak. Dr. Brantly answered the calling to serve those in need and experience a remarkable journey as the first person in the world to be treated with the experimental drug ZMapp, and the first person with Ebola to be treated in the United States when he was evacuated to Emory University Hospital. Dr. Brantly will share his extraordinary experience and his personal faith journey leading him to serve as a missionary doctor with Samaritan's Purse facing one of the deadliest viruses of our time.

Moderator: Lance Plyler, MD, Medical Advisor, Disaster Response and Programs, Samaritan's Purse



Lance Plyler



Kent Brantly

11:00am to 11:15am

Visit with Exhibitors
Salon A, Salons B & C and the Barber Room

11:15am to 12:15pm

Breakout Sessions 3: Three Sessions Running Concurrently



DOT™ THE APP EFFICACY STUDY

AN IN-APP STUDY OF A NEW FAMILY
PLANNING METHOD



LEARN MORE
DotStudy.org



BODY LITERACY QUIZ #KNOWYOURBOD

YOU LIVE WITH YOUR BODY EVERY
DAY. DO YOU REALLY KNOW IT?



TAKE THE QUIZ
KnowYourBod.org



STANDARD DAYS METHOD OF FAMILY PLANNING

10 REASONS TO INTEGRATE INTO
PROGRAMS



INTERACT
StandardDaysMethod.org



'GROWUP SMART' PUBERTY BROCHURES

EDUCATION FOR ADOLESCENTS,
PARENTS, AND COMMUNITIES



DOWNLOAD
BIT.LY/1F94CF3



LOVE, CHILDREN & FAMILY PLANNING

7 DISCUSSION GUIDES FOR CHRISTIAN
SMALL GROUPS



DOWNLOAD
BIT.LY/1BNHS3A



FAMILY PLANNING VIA IPHONE & ANDROID



CYCLEBEADS® APP
CYCLEBEADS.COM



TWODAY METHOD APP
2DAYMETHOD.COM

LEARN MORE AT
WWW.IRH.ORG

f **IRH.GEORGETOWN**
t **IRH_GU**



**Institute for
Reproductive Health**
Georgetown University

Session A: FBOs Share M&E & HSS Challenges, Successes & Lessons Learned | Salons B & C

Data collection and analysis and instituting quality control practices are crucial to the effectiveness of an organization's programs, and faith-based organizations are no exception. We will hear from three FBOs as they tackle these challenging areas:

- The Uganda Protestant Medical Bureau, Kiwoko Hospital Uganda and the Armstrong Institute of Patient Safety at Johns Hopkins Medicine USA are ensuring quality health care services and improving patient safety by adapting and implementing the Comprehensive Unit-Based Safety Program (CUSP) model.
- International Care Ministries (ICM), is a Philippine-based NGO that implements poverty alleviation programs via local churches. This session will explore how ICM integrates rigorous data collection with program monitoring, and the intersection with faith and health.
- SANRU in the DRC will share three M&E challenges it faces supporting evidence-based decision-making and improving health services to millions of people with an enormous amount of data.

Moderator: Lebohang Patricia Mothae, MPub, Executive Director, Christian Health Association of Lesotho

Speakers:

- Tonny Tumwesigye, MD, MSPH, Executive Director, Uganda Protestant Medical Bureau: *Spreading Quality Innovative and Cost Effective Care For Vulnerable Populations Through Hospital To Hospital Patient Safety Health Systems-A National and International Partnership Based Approach*
- Lincoln Lau, PhD, Director of Research, International Care Ministries: *Does the Level of Trust in Faith Leaders Affect Health Intervention Outcomes? Findings from a Child Malnutrition Intervention in the Philippines*
- Antoine Mafwila, MD, MPH, Chief of Monitoring and Evaluation, SANRU: *The Challenges of Evidence-based Monitoring and Evaluation in DR Congo*

Session B: Faith-based Leadership on Climate Justice: A Moral Imperative | East Room

This panel will address the challenge of climate change. Centered in voices of frontline community members, participants will hear about the experiences of communities in the United States impacted by sea level rise, shifts in agricultural yields, and extreme weather. We will also explore how communities are connecting with global south communities to engage in transnational and translocal organizing and participants will be guided in reflecting on the biblical basis for action on climate change. Finally, participants will hear about faith-based actions already happening across the United States and beyond, as well as specific, concrete ways that they can engage. Each participant will walk away with at least one commitment to taking action on climate change.

Moderator: Ray Martin, MPH, Executive Director Emeritus, Christian Connections for International Health

Speakers:

- Rev. Dele, MDiv, Founder, Soil & Souls
- Reverend Dottie Yunger, MDiv, Lead Pastor, Solomon's United Methodist Church

Session C: Holistic Faith-based Approaches to Healing Trauma and Building Healthy Families | Multi-Purpose Room

A strength of faith-based health care is the focus on the whole person, including physical and emotional and spiritual healing. We will hear about two programs designed to heal by serving the whole person, body, mind and spirit:

- Crisis Care Training International uses a holistic approach to heal the many wounded around our world, drawing on its experience offering refugees, street children, child soldiers, orphans and the sexually exploited an opportunity to know and trust God.
- A World Relief program works with churches in six countries to encourage healthier marriages in their communities through a program known as Families for Life.

Moderator: Paul Frank, PhD, Executive Director, SIL LEAD, Inc.

(Continued on page 41)



PLANNING TO SERVE AS A HEALTHCARE MISSIONARY?

HEALTHCARE MINISTRY IS OUR CALLING!



HEALTHCARE FOCUSED

Christian Health Service Corps is the only long-term missionary sending organization designed for healthcare professionals.



MISSIONARY DIRECTED

We exist to serve and support you in your mission, where you feel called; there are hundreds of facilities and programs that need your help.



DISCIPLESHIP CENTERED

Christ centered pre-field preparation customized for missionary health professionals. We understand the challenges of healthcare ministry.



MISSIONARY CARE ORIENTED

Providing spiritual, emotional and logistical support for our missionaries is the foundation of our ministry.

CHSC TRAINING PROGRAMS ARE OPEN TO THE PUBLIC

Introduction to Disaster and Refugee Response – SPHERE International Standards
Village Healthcare Intensive Section 1 – Global Health Principles and Practice
Village Healthcare Intensive Section 2 – Tropical Medicine Overview
Community Health Evangelism – CHE TOT 1

See our website for more information.

GET THE BOOK

When Healthcare Hurts: An Evidence Based Guide for Best Practices in Global Health Initiatives

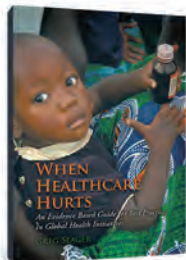

Scan this qr code with your smart phone or visit **amazon.com** and search **When Healthcare Hurts**



Proceeds from this book support CHSC missionaries serving around the world!

CHRISTIAN HEALTH SERVICE CORPS
PO Box 132 | Fruitvale TX 75127
www.healthservicecorps.org

United States: 1 210-888-9182
United Kingdom: 0151-324-2935
Australia: 02-8005-6892

NOTES

Speakers:

- Amy Wilson, Crisis Care Training International: *Effects of Trauma on Faith and Spirituality*
- Debbie Dortzbach, MPH, MN, Director of Health Social Development, World Relief: *Loving your neighbor: Your spouse*

12:15pm to 1:15pm Lunch
Nolan's Dining Hall

Theme Table

Translating Health Materials: A discussion about translating health materials into local languages and using Bloom software to facilitate the process, led by Paul Frank, PhD, Executive Director, SIL LEAD.

1:15pm to 2:00pm Visit with Exhibitors
Salon A, Salons B & C and the Barber Room

2:00pm to 3:00pm Breakout Sessions 4: Three Sessions Running Concurrently

Session A: Faith Leaders as Powerful Allies in Improving Maternal and Child Health | Salons B & C

Experience has shown that when religious leaders have accurate information about family planning, they become powerful champions, promoting the healthy timing and spacing of pregnancies in their communities. We will hear about three efforts to engage religious leaders in family planning promotion:

- A World Vision program in Kenya is showing early promising results in increasing uptake of both family planning and immunization through training primarily male Christian and Muslim religious leaders on how holy scripture supports healthy timing and spacing of pregnancies.
- The Advancing Partners and Communities Project, a USAID-funded partnership implemented by JSI and FHI360 has partnered with the Uganda Protestant Medical Bureau and CCIH to build the capacity of Ugandan religious leaders to talk about family planning/healthy timing and spacing of pregnancy.
- The Christian Health Association of Kenya is working with CCIH to address the unmet need for family planning by empowering religious leaders to advocate for improved resource allocation for FP and favorable public policy.

Moderator: Henry Mosley, MD, MPH, Professor Emeritus, Population, Family and Reproductive Health and International Health Departments, Johns Hopkins University Bloomberg School of Public Health

Speakers:

- Adrienne Allison, MA, MPA, Technical Advisor for Family Planning, World Vision, Integrating Healthy Timing and Spacing of Pregnancy and Immunization: *Removing barriers to integration and male opposition to increase uptake of both*
- Marta Pirzadeh, MPH, Senior Technical Officer for the Research Utilization Unit, FHI360: *Faith and family planning: using a holistic model of reproductive health promotion to assess knowledge, attitudes and uptake of family planning in Uganda*
- Jane Kishoyian, MPH, RN, Project Coordinator, Christian Health Association of Kenya: *Religious leaders as champions of change in family planning*

Session B: Lessons from HIV and Malaria for Faith-based Organizations in Africa's Transition to Managing NCDs | East Room

This session will explore lessons from successful HIV, malaria and other infectious disease programs and the ways that these can be the basis for innovative public-private partnerships to combat NCDs. We will hear about the model of partnerships between faith-based providers and Novartis, a global pharmaceutical company, to illustrate how FBOs can implement the call of the Addis Action Agenda for transformative PPPs to meet the Sustainable Development Goals. We will learn about other Christian partners with longstanding partnership models, hear an overview of the key achievements in the fight against malaria and some of the key success factors. The epidemiology of non-communicable diseases and malaria on a time-scale will also be examined.

Moderator: David Olson, Communications and Social Marketing Consultant, Olson Global Communications

Speakers:

- Jonathan Kiliko, MBA, PhD, Head of Customer Service, Mission for Essential Drugs and Supplies (MEDS)
- Samuel Mwenda, MD, Secretary General, Christian Health Association of Kenya
- Nathan Mulure, MD, MPH, MPharm, Cluster Head, Novartis Social Business, East and Southern Africa

Session C: Responding in a Time of Multiple Famines | Multi-Purpose Room

Our world faces multiple famines today, from Nigeria to Somalia, to South Sudan and Yemen. The severity of these famines challenge Christians to address them on a number of fronts: raising funds rapidly to provide emergency food, responding in the field with life-saving food and working with local governments and partners to respond. We will hear from organizations on the front lines of this massive crisis.

- As a faith-based organization, IMA World Health has the imperative to address critical needs in South Sudan. Its current nutrition programming includes outpatient treatment, targeted supplementary feeding, stabilization centers and community-based screening.
- AmeriCares is a global health and disaster response organization, responding across the world to acute disasters. Generating support for famine and associated disease outbreaks in the horn of Africa is fraught with challenges from delayed donor interest in slow onset disasters to concern over the safety of staff in insecure environments.
- Assisting 80 million people in about 80 countries each year, the World Food Programme is the leading humanitarian organization fighting hunger worldwide and is responding to this enormous crisis hitting multiple parts of the world.

Moderator: Lisa Firth, MB, MPH, Health Technical Advisor, Salvation Army World Service Office

Speakers:

- Dalia Eryani, MS, Senior Program Officer, IMA World Health
- Anne Peterson, MD, MPH, Senior Vice President, Global Programs, AmeriCares
- Jon Brause, MS, Managing Director, World Food Programme (*invited*)

3:00pm to 3:30pm

**Refreshments and Visit with Exhibitors
Salon A, Salons B & C and the Barber Room**

3:30pm to 4:00pm

Working Groups Meet (Session II)

Integration of Faith and Health | East Room
Health Systems Strengthening | East Room
Community-based Prevention & Care | Salons B & C
Health of Women & Children | Salons B & C

4:00pm to 5:45pm

Closing Plenary Session | Salons B & C

Welcome Message from Gold Sponsor

American Association of Pro-Life Obstetricians and Gynecologists: Christina Francis, MD, AAPLOG Board Chair

(Continued on page 46)



Professional Services to Safeguard Your Organization

You face an ongoing array of challenges as you work to fulfill your organization's mission. But you don't have to go it alone.

CapinCrouse provides valuable insight and solutions to help you guide your organization in its life-changing work.

This includes **expert cybersecurity services** to help you assess and reduce your organization's cybersecurity risk and safeguard your information systems, data, and public trust.

audits | reviews | tax | consulting | cybersecurity

capincrouse.com/cybersecurity

AN INDEPENDENT MEMBER OF
BDO
ALLIANCE USA

NOTES



**ENHANCE
YOUR PROGRAM**



**IMPROVE
PEOPLE'S LIVES**

Give the Gift of Sight!

544 million people live in developing countries with uncorrected near vision impairment due to the lack of access to available, affordable reading glasses. This is one of the biggest global health problems with one of the easiest, most cost-effective solutions.

ADD READING GLASSES TO THE WORK YOU DO, IT'S EASY, INEXPENSIVE, AND VERY REWARDING!

- ☑ MINIMAL COST AND EASY ADD-ON REGARDLESS OF YOUR PROGRAM FOCUS
- ☑ NO PROFESSIONAL TRAINING OR EQUIPMENT ARE REQUIRED
- ☑ EASY AND COST-EFFECTIVE TO TAKE IN SUITCASES OR SHIP



www.RestoringVision.org
(209) 980-READ (7323)
info@restoringvision.org

Presentation of 2017 Christian International Health Champion Award

The CCIH Christian International Health Champion Award recognizes an individual who has dedicated his or her life to global health from a Christian perspective, made significant contributions to the field and to the development of CCIH.

The award will be presented by Samuel Mwenda, MD, General Secretary, Christian Health Association of Kenya, Recipient of the 2016 CCIH Christian International Health Champion Award.

Recipient: Frank Baer, MHS-TM, DrPH, Vice President, SANRU



Frank Baer

Franklin Baer, MHS-TM, DrPH was among the founding members of CCIH, and proponent of including “Connections” as part of the name and mission of CCIH. He helped CCIH transition from an offshoot of the National Council for International Health (NCIH) conference to become an independent organization. He established CCIH’s Internet presence by securing the ccih.org domain name and hosting its first website. He recruited Ray Martin to “connect” with CCIH as a board member and later as Executive Director. Dr. Baer has served CCIH in various capacities – as vice-president, as conference program chair and as editor of “The CCIH Forum.” Through those efforts he has continuously championed CCIH’s mission to connect Christians in promoting global health from a Christian perspective, especially for health systems strengthening.

Dr. Baer has public health degrees from Antwerp, Johns Hopkins and Tulane, but acknowledges that he became a health systems development specialist through 45 years of program design, implementation and evaluation, primarily in Sub-Saharan Africa. He and his wife Retha began as volunteers with Mennonite Central Committee for seven years. From 1981-1991, he served as USAID’s project manager for the SANRU Basic Rural Health Project. SANRU, as managed by the Protestant Church of Congo, shaped Congo’s decentralized health zone system, including the role of faith-based partners as health system managers.

In 1991, Dr. Baer and his family were evacuated from DRC. After considerable thought and prayer he realized that the “closing door” in DRC was “opening a window” to share his experiences. So, he began working as an independent consultant under the name Baertracks. He has worked in more than 30 countries and led numerous USAID, World Bank and faith-based teams to design health systems development (and rebuilding) projects.

Although he is slowly easing into retirement he continues working as an independent consultant, as a senior advisor to IMA World Health and as vice-president of SANRU NGO. And, in his spare time, he manages a large network of BeMoreCreative quotation-inspired websites to encourage *Thinking, Working and Living More Creatively*.

How to Engage with Donors to Leverage Faith Work

The commitment, influence and efficiency of faith-based organizations working in development is being increasingly recognized, including by donors. Organizations supporting global health work want to engage with faith groups and FBOs are finding diversified funding sources beyond their traditional donors helps leverage their work. Representatives from donor organizations and a resource development expert will share their thoughts on how FBOs can successfully engage with donors, working towards a partnership to serve an even greater number of people in need.



Anne Peterson



Will Moore



David Stanton



Joan Geiger Wood

Moderator: Anne Peterson, MD, MPH, Senior Vice President, Global Programs, AmeriCares

Speakers:

- William Moore, Executive Director, Eleanor Crook Foundation
- David Stanton, MSN, MPH, Acting Deputy Assistant Administrator, USAID Bureau for Global Health
- Joan Geiger Wood, CFRE, Joan Wood & Company

5:15pm to 5:30pm

Discussion of Key Points and Takeaways: Doug Fountain, Vice President for Strategy and Impact, Medical Teams International and CCIH Board Vice President

5:30pm to 5:45pm

Closing Remarks: Bob Blees, Interim Executive Director, CCIH

NOTES

Thank You To Our Committee Members

Conference Planning Committee

Jerilyn Cox, BSN, RN, Whitman-Walker Health
Jonathan Giles, MPH, Liberty University Department of Public and Community Health
Amy Hewitt, International Aid
Lauran Holton, Samaritan's Purse
Cathleen Miller, MSN, CNM, MAMA Project
Henry Mosley, MD, MPH, Johns Hopkins University Bloomberg School of Public Health
Kristen Panico, MSPH, University Research Co.
Laura van Vuuren, Global Health Consultant
CCIH Staff: Mona Bormet, MPH, CHES and Kathy Erb

Abstract Review Committee

Allison Flynn, MPH, World Relief
Paul Frank, PhD, SIL LEAD
Douglas Huber, MD, MSc, CCIH FP/RH Committee Co-Chair
Ray Martin, MPH, CCIH
Ron Mataya, MD, MPH, Loma Linda University School of Public Health
Henry Mosley, MD, MPH, Johns Hopkins University Bloomberg School of Public Health
David Olson, Olson Global Communications
Anne Peterson, MD, MPH, Americares
Rachel Parrill, PhD, RN, APHN-BC, Cedarville University School of Nursing
Lance Plyler, MD, Samaritan's Purse
CCIH Staff: Mona Bormet, MPH, CHES and Kathy Erb and former CCIH Staff Maddie Orange, MPH

Scholarship Review Committee

Ray Martin, MPH, CCIH
Henry Mosley, MD, MPH, Johns Hopkins University Bloomberg School of Public Health
Jim Oehrig, MA, American Leprosy Missions
David Olson, Olson Global Communications
Kris Panico, MSPH, University Research Co.
Laura van Vuuren, Global Health Consultant
CCIH Staff: Mona Bormet, MPH, CHES

Youth Pre-Conference Planning Committee

Adrienne Allison, MA, MPA, World Vision
Debbie Dortzbach, MPH, MN, World Relief
Allison Flynn, MPH, World Relief
Nancy Pendarvis Harris, MPH, John Snow Research & Training Institute
Douglas Huber, MD, MSc, CCIH FP/RH Committee Co-Chair
Jane Kishoyian, MPH, RN, Christian Health Association of Kenya
Claudia Llanten, MD, MPH, Catholic Medical Mission Board
Mirfin Mpundu, PharmD, MPH, MBA, Ecumenical Pharmaceutical Network
Ngalande Ngalande, Jr., LLB, Churches Health Association of Zambia
Samuel Shanju, HSM, Ecumenical Pharmaceutical Network
Lucy Simiyu, MPH
Donna Terpstra, It's our Mission! Period
Tonny Tumwesigye, MD, MSPH, Uganda Protestant Medical Bureau
Lauren Van Enk, MPH, Institute for Reproductive Health at Georgetown University
CCIH Staff: Mona Bormet, MPH, CHES and Kathryn Parker, MA

Speaker Bios

Perpetua Alfazema

Perpetua Alfazema is the Executive Director of the Kuwangisana Project. She had a vision of helping people affected by HIV/AIDS and worked with the community in 2005 to develop the Kuwangisana Project. Ms. Alfazema earned her Bachelor degree in Sustainable Business from Maharishi University of Management in 2013 and has a diploma in social work and health. She speaks several languages and aspires to be a role model for women in her community.

Adrienne Allison

Adrienne Allison, MA, MPA, has served as the Project Director for the Integrated Birth Spacing Project and the Technical Advisor for Family Planning for World Vision US since 2007. She has worked in Family Planning and Reproductive Health for 30 years, including living and working in Malawi and Bangladesh before joining USAID's Office of Population and Reproductive Health. Later, she managed the Child Survival program in

the Office of Private and Voluntary Cooperation and designed USAID's first grants program to enable international nonprofit organizations to integrate HIV/AIDS activities into their health programs.

Franklin Baer

Frank Baer, MHS-TM, DrPH has public health degrees from Johns Hopkins and Tulane, but he became a health systems development specialist through 40 years of program design, implementation and evaluation, primarily in Africa. From 1981-1991 he played a key role in developing DR Congo's decentralized health zone system as project manager of the SANRU Basic Rural Health project. As an independent consultant, since 1991, he has led numerous USAID, World Bank and faith-based teams to design health systems development projects, including DR Congo, Liberia and South Sudan. He serves as a Senior Advisor to IMA World Health and as Vice President of SANRU.

Cedarville University

 **online M.S.N.**

**Combining Nursing Excellence
With Christian Compassion**

- » Three tracks (Family Nurse Practitioner, Global Public Health Nursing, and Nurse Educator)
- » Flexible, convenient completion options
- » Competitive costs and available financial aid

Apply now:

cedarville.edu/msn



CEDARVILLE
UNIVERSITY.



Eloho Basikoro

Eloho Basikoro, PhD is a recent graduate from the University of Washington Seattle with a cross disciplinary research interest in health and medical geography, critical development studies, feminist political ecologies of health, women/gender, and HIV/AIDS. Her personal experience of place coming from a resource-rich but politically challenged country like Nigeria, her Christian faith and positionally as a woman are critical parts of her identity that have intersected to influence her passion and interest in global health and international development. She hopes to use her faith to make a difference, one person at a time.

Bob Blees

Bob Blees serves as Interim Executive Director of Christian Connections for International Health. He also serves as SIM USA Vice President and SIM Global Services support. Mr. Blees joined SIM in 1980 as a Services Division mechanic and Services Division Director in Liberia. He later went on to serve as ELWA ministries manager

overseeing its five divisions which included Services, Hospital, ELWA Academy, West Africa Christian High School, ELWA Broadcasting, Print Shop and Dental Clinic. For the past 25 years, Mr. Blees has served as Vice President of SIM USA, and has contributed to the management of SIM worldwide operations.

Kent Brantly

Kent Brantly, MD was awarded as one of the Time Magazine Persons of the Year for 2014 for his courageous service treating patients during the Ebola outbreak as a medical missionary at ELWA Hospital in Monrovia, Liberia. Dr. Brantly is a Family Medicine physician who received his Medical Degree from Indiana University School of Medicine. He completed his Family Medicine Residency and Fellowship in Maternal Child Health at John Peter Smith Hospital in Fort Worth, Texas. Prior to entering medical school, he received his Bachelor of Arts in Biblical Text from Abilene Christian University in Abilene, Texas.



Join us in delivering

Healthier Lives Worldwide

 541,575 People supported with health services	 8,732 Days of service from volunteers in 17 countries	 \$357 million Worth of donated medicines and medical supplies distributed in 29 countries
--	--	--



Connect with Us

[Partner](#) [Volunteer](#) [Donate](#) [Meet Your Angel](#)

100 Wall Street, 9th Floor, NY 10005

cmmb.org



Jon Brause

Jon Brause, MS serves as Managing Director, World Food Programme and is a senior policy maker with 30+ years of experience in the areas of international humanitarian assistance, disaster response, agency-level budget development and management, and business process reengineering. He has experience in senior-level interagency and international negotiations on subjects such as annual budget development, interagency disaster response coordination, and North Korean food assistance.

Amberle Brown

Amberle Brown, RN, MSN, MPH joined World Relief after graduating from Johns Hopkins University in December 2016, having obtained her Master of Science in Nursing and Master of Public Health degrees with a focus on global health. Prior to graduate school, Ms. Brown worked as an ICU nurse and interned with global health organizations like WHO and Baptist Global Response. Her areas of interest and research include HIV/AIDS, community-based public health, disability-inclusion, and maternal child health.

Emma Smith Cain

Emma Smith Cain, MA is a humanitarian practitioner with a passion for women and children. She earned her BA cum laude in History and Geography from Dartmouth College in 2013 and, as a Harry S. Truman Scholar, she earned her MA with distinction in Human Rights from the University College London in 2014. She was responsible for developing Samaritan's Purse's protection sector in the Democratic Republic of Congo and leading the first year of their protection programming. She is now US-based and consults on international program development for several organizations including Christians for Biblical Equality and Congo Initiative.

Rachel Clement

Rachel Clement, MA is a Policy Associate at the International Center for Research on Women (ICRW). She is a co-chair for the Girls Not Brides USA coalition and is on the Steering Committee of the Coalition for Adolescent Girls. Ms. Clement works to implement advocacy strategies and monitor relevant foreign policy developments

within the U.S. Government. She has worked at the Department of State, Big Brothers Big Sisters, and Plan International, and in Ecuador, Vietnam, Russia and the Philippines on youth and gender issues. She earned her BA from the University of Colorado and her MA in International Development from the George Washington University.

Jerilyn Cox

Jerilyn Cox, BSN, RN is a community health nurse in the District of Columbia, where she manages the medical care for patients with HIV and chronic diseases. She helps patients creatively overcome barriers to managing health conditions through direct services and referrals and advocates for policies to improve the care provided by local health systems. Prior to this, Ms. Cox worked in Haiti with Samaritan's Purse on a project aimed at enhancing maternal and child health. She graduated from Cedarville University with a Bachelor's of Science in Nursing in 2014. She is originally from the Philippines and Papua, New Guinea.

Nana Apenem Dagadu

Nana Apenem Dagadu, MPH is a Senior Research Officer and Instructor at Georgetown University's Institute for Reproductive Health (IRH). At IRH, she is responsible for supporting Monitoring, Learning, and Evaluation, research, and technical assistance efforts across projects. Ms. Dagadu's current research focuses on transforming social norms to prevent gender-based violence, eliminate health disparities, and empower adolescents throughout life. She is most enthused by her work documenting systematic approaches of scaling up evidence-based programs that expand reproductive choice and improve lives globally.

Rev. Dele

Rev. Dele, MDiv is the Founder of Soil & Souls. She is a grandmother, theologian, and Climate Reality Leader who uses her skills as a permaculturist and contemplative to assist churches train the next generation of mission leaders in faith, ecology and policy. Dele's B.A. is from University of California-Riverside and her M.Div. is from Howard University School of Divinity. She serves in the Central Atlantic Conference of the UCC and maintains Baptist affiliations.

Deborah Dortzbach

Deborah Dortzbach, MPH, MN is a nurse specialist in international public health and child health with extensive experience in community-based health assessment, program design, implementation, training, advocacy, and media and material development. She presently works at World Relief in Baltimore and has many years of experience in HIV/AIDS, youth and children's health, family and maternal health working in Africa, Asia, and the Caribbean. She co-authored four books, *The AIDS Crisis: What We Can Do*, *The Mother Child Project*, *Integrating Faith and Healthcare: Shalom* and *the Mission Health Movement*, and *Kidnapped*, chronicling her experiences as an early missionary in 1974.

Anbrasi Edward

Anbrasi Edward, PhD, MPH, MBA, MSc is full-time faculty at the Center for Refugee and Disaster Studies in the Department of International Health at Johns Hopkins Bloomberg School of Public Health. Her primary focus is on health systems performance evaluations and frameworks, quality of primary

health care for pediatric patients, and community-based research in transitional economies. She has engaged in research projects with the World Bank, WHO regional centers, DFID, PAHO, and several USAID-supported agencies. Dr. Edward currently co-directs the MPH Health Leadership Management concentration and is a co-instructor for several management courses at the School of Public Health.

Gloria Ekpo

Gloria Ekpo, MD, MPH is Senior Technical Advisor for HIV and AIDS at World Vision and has over 30 years of experience in clinical and public health practice in Maternal Child Health, HIV/AIDS, Adolescent health, SRH/Family Planning, community health research and program management. Prior to joining World Vision, Dr. Ekpo worked as the Technical Officer for Pediatric HIV for USAID/BASICS Project and served as the HIV/AIDS Technical Officer in the AIDSRelief Consortium-Track 1 PEPFAR Awardee. She received her MPH from Johns Hopkins University Bloomberg School of Public Health, and her Medical Degree from Ahmadu Bello University in Nigeria.

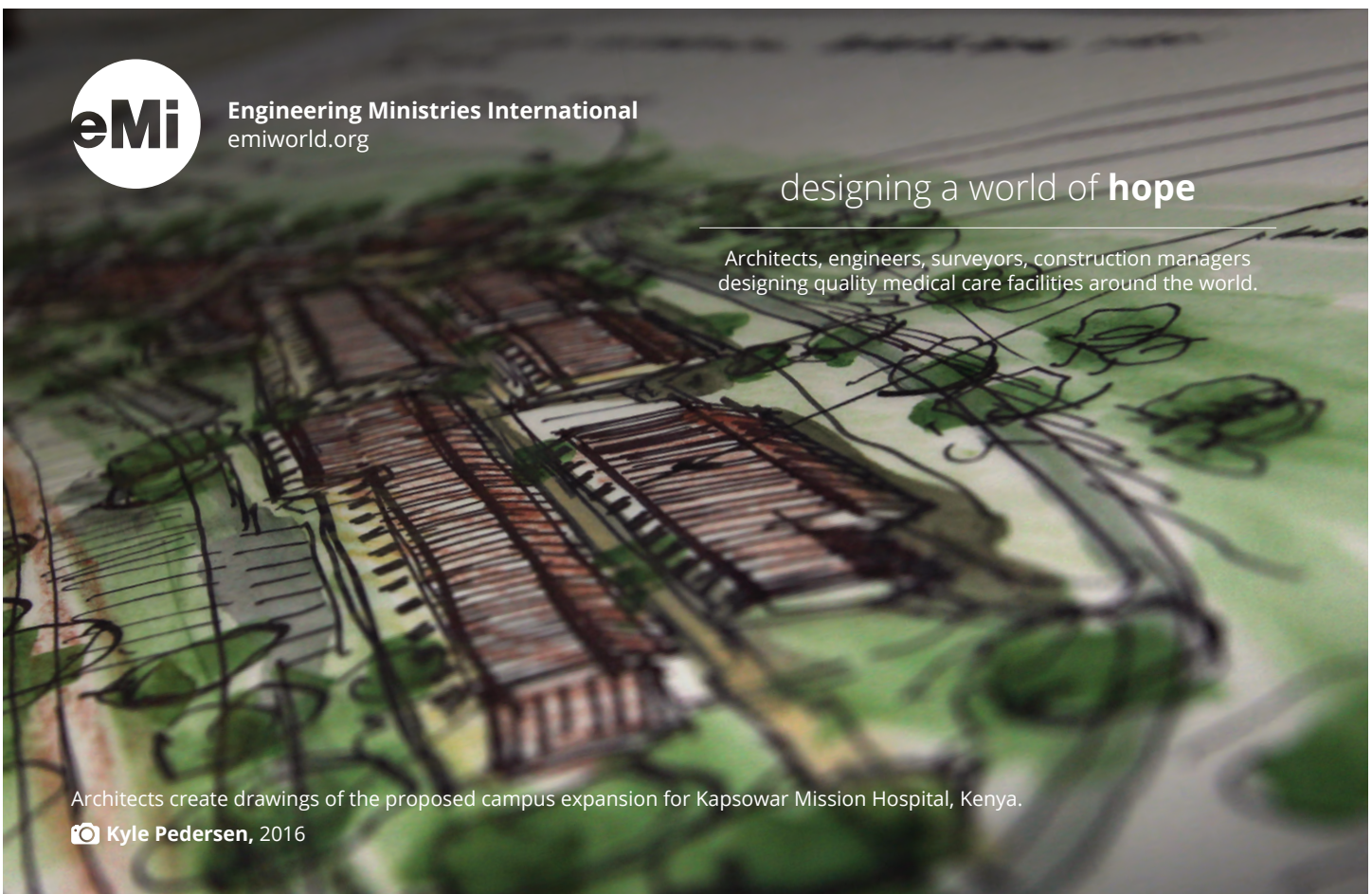

Dalia Eryani

Dalia Eryani, MS is a Senior Program Officer at IMA World Health and leads IMA's South Sudan portfolio. Before joining IMA, she provided support to country programs in Ethiopia, Indonesia, and Yemen with JSI. Ms. Eryani has also explored contraceptive security in post-conflict countries with USAID, worked at the White Ribbon Alliance advocating for respectful maternal care, and explored opportunities for improved hygiene with IRD. She has experience as part of a USAID-funded health systems strengthening project that worked on geographical and health information systems and other projects focused on raising community awareness about the safe age of marriage in Yemen.

Lisa Firth

Lisa Firth, MB, MPH, serves as the Health Technical Advisor for SAWSO (The Salvation Army World Service Office) where she supports US-funded health projects run by Salvation Army territories overseas. Prior to joining SAWSO in 2013, Dr. Firth worked as a Program Development Advisor for Samaritan's Purse and as Assistant Director of International AIDS Programs at World Relief. This followed a 20-year career in US domestic public health, most recently as Assistant Commissioner of Health for Baltimore City. She received her medical degree from the University of London and clinical training in OB/GYN through the British National Health Service.

Allison Flynn

Allison Flynn, MPH is based in Baltimore and is a Program Advisor for Health & Nutrition at World Relief. She has experience in community engagement, behavior change, and nutrition programming, primarily serving Asia and sub-Saharan Africa. Ms. Flynn is an active participant in CCIH's advocacy efforts for MCH and family planning. She holds a BA in International Relations and Human Needs and Global Resources from Wheaton College and an MPH in Global Maternal and Child Health from the University of Illinois at Chicago.

Christina Francis

Christina Francis, MD is the President of the Board of the American Association of Pro-Life Obstetricians and Gynecologists and is an Obstetrics/Gynecology specialist in Fort Wayne,

Indiana. She graduated from Indiana University School of Medicine in 2005, and has over 12 years of diverse experience. She has always had a passion for human rights, spending a significant portion of the past 10 years in various countries working on behalf of women and children. Dr. Francis spent time working with orphans in Romania and Burma and worked for three years as the only OB/GYN in a mission hospital in rural Kenya.

Paul Frank

Paul Frank, PhD is Executive Director of SIL LEAD, Inc., a non-profit NGO dedicated to serving minority language communities. He has a PhD in linguistics and experience in applied linguistic research and the management of development programs in minority language communities. Dr. Frank oversees SIL LEAD's participation in USAID reading interventions, including programs in Ethiopia, Ghana, DRC, Senegal, Afghanistan, and Nepal. He is an advocate for the use of local languages for effective health programs. He also is a Master Trainer for Bloom book creation software, which makes it straightforward for local language speakers to write or translate literature into their own languages.

Jonathan Giles

Jonathan Giles, MPH is the Assistant Dean for the School of Health Sciences at Liberty University. Prior to that position, Mr. Giles was the Director of Practica at Liberty University where he assisted the Dean of the School of Health Sciences in academic operations and worked with University departments on cross-departmental efforts involving the Quality Enhancement Plan and also served as the Practicum Coordinator. He has a BS in Public Health Education and Promotion from Liberty. Mr. Giles has served in a number of volunteer roles supporting the CCIH conference planning and logistics.

Kathy Griffith

Kathy Griffith, a nurse trained in her homeland of Zimbabwe and in South Africa, has worked in several countries with Maternal, Neonatal and Child Health as an implementer, a trainer of Community Health Workers, a Grants Officer for Community-based Primary Health Care, and now as the Program Manager for Maternal, Newborn and Child Health for the Global Health Unit, Global Ministries, The United Methodist Church. She has always seen this as her calling, mission, and opportunity.

Nancy Pendarvis Harris

Nancy Pendarvis Harris, MPH serves as Vice President of John Snow Research & Training Institute, Inc. and has been a thought leader in international health for four decades, with field assignments in Africa, Eastern Europe and Latin America and visited over 80 countries for short-term technical support. A long-time champion of the positive role faith organizations can play in improving health among the world's poorest people and in strengthening health systems, she was a pioneering member of CCIH and served many years on its Board of Directors.

Chad Hayward

Chad Hayward is the Executive Director of the Accord Network. Prior to that, he served as the Senior Advisor for the Center for Faith-Based and Community Initiatives at USAID. He spent several years working on Capitol Hill, where he served as Communications Director for Representative Jim Ryun of Kansas and as Policy Aide to Representative John Thune of South Dakota.

Before his time in Washington, DC, Mr. Hayward worked as Director of Operations for Prayer for the Persecuted Church, an organization working to encourage involvement among the church in the area of persecuted Christians worldwide.

Ann Hershberger

Ann Hershberger, PhD is a Professor at Eastern Mennonite University and has worked in family health, community health, international health, and nursing education since 1976. Dr. Hershberger earned her PhD from the University of Virginia, completing a dissertation related to the relationships between NGOs, donors, communities, and the Ministry of Health in Nicaragua. Other research includes the experiences of families in Guatemala and the West Bank who have hosted EMU Cross Cultural students over several decades. She has been a consultant for a Nursing School in Nicaragua, and on various boards of the Mennonite Central Committee, and is currently the chair of MCC U.S.



Lauren Herzog

Lauren Herzog, MA is a Program Coordinator at World Faiths Development Dialogue. She holds a master's degree in French and international development from the University of Wisconsin-Madison and has lived and worked in both Senegal and Congo-Brazzaville. Prior to joining WFDD, Ms. Herzog implemented health programs within Chicago's African immigrant community.

Amy Hewitt

Amy Hewitt is a Grant Writer and the Manager for the Lab-In-Suitcase® (LIS) Program with International Aid. The LIS brings accurate diagnostic testing to rural areas of the world, Ms. Hewitt oversees distribution, communications, grants and updates to the program. Previously, she served as Partner Development Manager for IA's Medical Equipment Services. In these roles, Ms. Hewitt connects with mission-minded organizations working in global health development to assess and deliver appropriate and sustainable medical equipment to rural clinics and hospitals. Her interests are advocating for global health, gender equality, social justice and writing, and she serves on the CCIH Board of Directors.

Douglas Huber

Douglas Huber, MD, MSc has worked 40 years in international health with a focus on reproductive health, research, and innovative community health implementation. He was trained in medicine at the University of Colorado, in international public health at the London School of Hygiene and Tropical Medicine, and in medical epidemiology at the US Centers for Disease Control. He was on the WHO Expert Working Committees to establish the Medical Eligibility Criteria for Contraceptive Use and develop Family Planning training materials for health providers. In 2014 Dr. Huber received the APHA Life-time Achievement Award in International Health and the CCIH Christian International Health Champion Award.

Wendy Jolley-Kabi

Wendy Jolley-Kabi, MPA is President and CEO of Global Health Action, a CCIH affiliate. She is an experienced leader of development and social justice organizations, who has successfully led nonprofit organizations and membership

associations in North America and southern Africa for more than 15 years. A lifelong advocate for vulnerable children and individuals worldwide, Ms. Jolley-Kabi has served as Executive Director for the Association of Missing and Exploited Children's Organizations (AMECO) and as the Program Manager and Director of Lesotho Save the Children in southern Africa. She served with the US Peace Corps in Lesotho as a Community Rural Development Specialist.

Jeffrey Jordan

Jeffrey Jordan, MPA is President and CEO of Population Reference Bureau and provides strategic leadership and vision for the organization. Prior to PRB, Mr. Jordan was the Senior Vice President for International Programs at Catholic Medical Mission Board and managed CMMB's field staff and the medical volunteer program, and oversaw the monitoring and evaluation unit and the grants acquisition department, in addition to oversight of all international health programs. He holds a master's degree in public affairs from Princeton University and a bachelor's from Davidson College. Mr. Jordan is a member of the Board of Directors of IMA World Health.

Jackie Katana

Jackie Katana, MPA is International Advocacy Officer at DSW/Faith to Action. She has 15 years experience implementing reproductive health programs and advocacy globally, 10 of which were working with faith-based organizations. Ms. Katana has experience with Civil Society Partnership programs and in implementing programs in HIV/AIDS, Disability, Child Protection, Gender, Emergencies and Crisis Recovery, Environment Management, Organizational Capacity Assessment and Building and practical experience in proposal writing, fundraising and advocacy.

Jonathan Kiliko

Jonathan Kiliko, MBA, PhD is the Head of Customer Service for MEDS (Mission for Essential Drugs and Supplies) and has over 25 years of experience in senior management in medical supply chains. Dr. Kiliko oversees the functions of customer care and distribution, special projects, capacity building, partnerships, marketing and

business development, public relations and corporate communication. He has a Masters in Business Administration and a PhD in Business Administration in Strategic Management (both from the University of Nairobi, Kenya).

Jane Kishoyian

Jane Kishoyian, MPH, RN serves as a Project Coordinator with the Christian Health Association of Kenya (CHAK). Ms. Kishoyian coordinates Reproductive, Maternal, Newborn and Child Health programs for CHAK and manages the Family Planning project supported by the Bill & Melinda Gates Foundation in collaboration with CCIH, the Churches Health Association of Zambia and the Ecumenical Pharmaceutical Network.

Grace Kreulen

Grace Kreulen, PhD has assisted NGOs in the development, implementation, and evaluation of community-based MNCHN projects and currently

serves as a health program consultant with World Renew. She is a public health professional with a research PhD and experience leading research and evaluation projects focused on promoting access to quality health care for the underserved poor.

Cate Lane

Cate Lane, MPH is the Youth Advisor with USAID's Office of Population and Reproductive Health where she provides guidance and technical support to global and mission-level activities around evidence-based and best practices in adolescent sexual and reproductive health programs. Prior to joining USAID, Ms. Lane held positions with Pathfinder, Futures Group, CEDPA and Advocates for Youth, always with a focus on adolescents. She holds a Master's in Public Health with an emphasis on Health Behavior and Education from the University of Michigan.



CHRISTIAN JOURNAL for GLOBAL HEALTH

New Issue: Family Planning

Since June 2014, publishing articles on global health that are open-access (freely available), scholarly (thoughtful and peer reviewed), with a diverse intercultural and inter-denominational Christian perspective. Integrative articles draw upon multiple disciplines in health and theology. Increased understanding of health and healing is missional and stimulates a new level of conversation for the healing of the nations.

Consider: Original Research Articles, Review Articles, Case Studies, Commentaries, Field Reports

Beside General Submissions, **New Calls for Papers: Palliative Care, Dying & Planetary Health**

To register as a reader, review articles, submit an article, and support the project visit journal.cjgh.org



OPEN ACCESS



SCHOLARLY



INTERCULTURAL



MISSIONAL



INTEGRATIVE



CONVERSATIONAL



Bruce Larkin

Bruce Larkin, MPH is the Health and Nutrition Program Manager with Samaritan's Purse in Niger. He is a graduate of the University of Illinois at Chicago School of Public Health and from Wheaton College (BS). He enjoys running, anything related to basketball, and witnessing God work in the heart of the new believer.

Lincoln Lau

Lincoln Lau, PhD was inspired to study public health during a CIDA-funded internship in Bangladesh. He received his PhD in infectious disease epidemiology from the University of Hong Kong, and is currently the Director of Research for International Care Ministries in the Philippines, as well as an adjunct faculty member of the School of Public Health, University of Toronto. His primary research interests are around how to improve the effectiveness of health and poverty interventions in challenging settings.

Linda Lehman

Linda Lehman, MPH is an Occupational Therapist with a Public Health degree from Emory University. She initially worked in the US but has lived and worked the last 34 years in Brazil. She has provided technical support in South America, Africa and Asia with leprosy, Buruli ulcer, and other NTDs with disease control and disability prevention activities for Governments, NGOs, WHO and PAHO. She received the ASHT 2005 Paul W. Brand Award for Professional Excellence and received the Damien-Dutton Award in 2014 for Leprosy.

Claudia Llanten

Claudia Llanten, MD, MPH is Catholic Medical Mission Board's Senior Maternal and Child Health Specialist and former Country Director for Peru. Currently she is focused on program design, implementation and research for maternal and child health, with special emphasis on facility



International Aid

**We're In the Field
With You...**

Wherever You Are!

- Biomedical Services & Assessments
- Medical Equipment & Supplies
- Healthcare Products
- Lab-In-A-Suitcase
- Hygiene Kits

www.internationalaid.org
17011 Hickory Street
Spring Lake, MI 49456
800.968.7490 616.846.7490
info@internationalaid.org

ECFA
GUIDESTAR
PLATINUM
ACCREDITED

and community IMCI and community case management. Dr. Llanten has devoted her life to serving those most vulnerable in communities around the world in Latin America and African countries. She worked as a physician in her native Colombia, leading her hospital's effort to provide social and clinical services focused on child growth and development, including nutritional interventions for families living in poverty.

Jennifer Winestock Luna

Jennifer Winestock Luna, MPH has more than 25 years of experience in international health, particularly in maternal, newborn and child health, reproductive health, HIV/AIDS, health equity and gender. She has worked for USAID, ICF (MACRO), Johns Hopkins Bloomberg School of Public Health, Realizing Global Health, and nongovernmental organizations and donor organization networks. She has a passion for

using monitoring and evaluation information to improve project management and better communicate about project accomplishments, so that individual and organizational contributions to improving public health can be increased.

Antoine Mafwila Lusala

Antoine Mafwela Lusala, MD, MPH is a medical doctor with an MPH in Engineering of Health Information Systems. He has worked professionally for more than 10 years as a Monitoring and Evaluation (M&E) expert. Since March 2016 he has served as the Chief of Monitoring and Evaluation for SANRU. Prior to SANRU, he worked as a M&E specialist for the USAID DRC Mission, as the M&E Advisor for ICAP/Columbia University and as a M&E specialist for PATH.

God in HIS wisdom:

- *fashioned* the woman's form
- *designed* the process and method
- *created* menstruation
- *entrusted* the woman to carry life

Without menstruation, there is no life.

Being a woman *is not* a curse.

Increase *your* impact!

Reach out to women with this powerful yet practical project by training with the

TOOLKIT PACKAGE & EMPOWERMENT PACK

*Empowered with truth.
Equipped with skills.
Setting women free to be all
God created them to be.*

www.its-our-mission-period.org



Embracing the wonder of womanhood — without stigma or shame

Ray Martin

Ray Martin, MPH is Executive Director Emeritus of Christian Connections for International Health. Mr. Martin served as Executive Director of CCIH from 2000 to 2014. He has 45 years experience as an international development and public health specialist and was chief of the Health, Population, and Nutrition offices in Zaire, Pakistan, and Cameroon for USAID. In October 2012, he received a Lifetime Achievement Award from the International Health Section of the American Public Health Association and in September 2013, he received the Johns Hopkins University Knowledge for the World award for alumni who exemplify the Johns Hopkins tradition of excellence.

Matthew Megill

Matthew Megill, MD has served as a missionary physician at SIM Galmi Hospital since 2008. He is Director of HIV Programs and supervises programs providing medication and screening to thousands of patients every year. Dr. Megill also oversees grant-writing and reporting in SIM partnerships

with the Canadian International Development Agency and Tearfund and has presented research at the International Conference on AIDS and STIs in Africa and at IDWeek (Infectious Disease Conference).

Paul Mikov

Paul Mikov, MA is Vice President for Institutional Partnerships at Catholic Medical Mission Board (CMMB) and an Adjunct Professor in the School of Political Science at Fordham University. In his CMMB role, Paul is responsible for advancing partnerships with leading foundations, corporations, academic entities, large health-care networks, and relevant UN and governmental agencies. He has most recently been Director of Development and a Visiting Scholar at the School of International and Public affairs at Columbia University in New York City. Prior to Columbia University, for about 10 years, Paul held leadership roles at World Vision International, where he was the organization's main UN Representative.



Join Our Team!!!

Since our first hospital opened in Kenya in 1998, we have had over 3.3 million outpatient visits, provided over 230,000 life-changing surgeries, and trained over 8,100 medical professionals

Our hospitals and programs cannot function without a team of dedicated, talented professionals. We need YOU to consider joining our team so that we can keep doing what we're doing!

We are recruiting for the following position(s)

- *Pediatric & Adult Orthopedic Surgeon*
- *Anesthesiologist*
- *Pediatrician*
- *Hospital Administrator*
- *Short-Term Volunteers (Medical and Non-Medical)*

For more information, please visit: www.cure.org or contact HR@CURE.org

William Moore

William Moore is the Executive Director of the Eleanor Crook Foundation, a philanthropy based in Austin, Texas for research, innovation, and advocacy in international nutrition and food security. He was formerly Chief Storyteller at the United Nations Millennium Campaign, where he helped coordinate UN country office engagement plans for the Sustainable Development Goals, and worked to highlight the human aspect of data and development. Mr. Moore serves on the Board of Directors for Bread for the World, and is a co-chair at the Open Road Alliance. A North Carolina native, he graduated with top marks from Columbia University with a degree in American Studies.

Henry Mosley

Henry Mosley, MD, MPH is Professor Emeritus in the Population, Family and Reproductive Health and International Health Departments at the Johns Hopkins University Bloomberg School of Public Health. Dr. Mosley has worked for over 40 years in international public health programs, spending time

in education and research in Pakistan, Bangladesh, Kenya, and Indonesia. He has published over 140 scientific papers covering areas such as infectious and parasitic diseases, demographic and population studies, reproductive health, and child survival. Dr. Mosley was the 2015 recipient of the CCIH Christian International Health Champion Award.

Lebohang Patricia Mothae

Lebohang Patricia Mothae, MPub is the Executive Director of the Christian Health Association of Lesotho (CHAL). Before coming to CHAL, she lectured at the University of Free State in South Africa and Limkonkwing University of Technology in Lesotho for about seven years in the areas of Public and Municipal Administration, Public Finance Management and Human Resources Management. Ms. Mothae authored 11 peer-reviewed papers out of which three articles were published in accredited journals and one appeared as a chapter in a text. She serves as the Vice Chair of the Africa Christian Health Associations Platform.

Compassionate Care Worldwide

Our unique social enterprise allows us to improve the quality of training, diagnosis and treatment available to persons living with epilepsy and associated psychiatric disorders in under-resourced areas of the world.



Partnering with  OWP Pharmaceuticals

Rachel Moynihan

Rachel Moynihan, MA serves as the Advocacy and Communications Specialist in the Washington Office of the United Nations Population Fund (UNFPA). In her role, Ms. Moynihan serves as a liaison with the U.S. Administration, Members of Congress, civil servants and key NGO partners. She joined UNFPA after five years with The Glover Park Group, a leading strategic communications and government affairs firm headquartered in Washington. Ms. Moynihan holds a Master's Degree in Public Policy from George Mason University, and a Bachelor's Degree in Foreign Affairs from The University of Virginia.

Mirfin Mpundu

Mirfin Mpundu, PharmD, MPH, MBA is the Executive Director of the Ecumenical Pharmaceutical Network and Head of Action Against Antibiotic Resistance (ReAct) Africa. He is a pharmacist and public health specialist with more than 20 years extensive

experience in pharmaceutical systems, supply chain management, pooled procurement and contract management. His experience also includes achievement in technical assistance in pharmaceutical system strengthening, health product supply, quality assurance management for African health systems and global-level experience and achievement in leadership in public health procurement and supply system practice, capacity building and skills transfer.

Wilma Mui

Wilma Mui, MPH is a Program Associate at World Faiths Development Dialogue (WFDD). Ms. Mui served as a Peace Corps volunteer in southern Senegal from 2010 to 2013, working with local communities on a variety of health topics. Before joining the WFDD team, she worked with the Grandmother Project in Senegal as a community health and development consultant. She has an MPH in Global Health from Emory University.



Nathan Mulure

Nathan Mulure, MD, MPH, MPharm was born in Nairobi, Kenya, one of a family of seven brothers and sisters. He attended medical school in Nairobi and earned his MD in 1997. Dr. Mulure started work in the emergency room of Kenyatta National Hospital, and then worked for Doctors Without Borders in the world's largest refugee camp, Dadaab. In 2006 he started working for Novartis on clinical trials for the first ACT developed specifically for children with malaria. He now leads Novartis Social Business, East and Southern Africa. He has an MPH from the University of Liverpool, and a Master's in Pharmaceutical Medicine from Hibernia College.

Rhona Murungi

Rhona Murungi, MA is World Relief's Program Officer for the Developing Countries Unit, where she supports World Relief's programs in Burundi, Kenya, Rwanda and Haiti. She was the Director of Programs for World Relief Rwanda for two years and oversaw programs in Child and Youth Development, Agriculture, Orphan and Vulnerable Children, Maternal and Child Health,

Nutrition, Church Empowerment and Savings. She holds a MA in Economic Development from Vanderbilt University and a BA in Developmental Economics and Accounting from Taylor University. She is currently pursuing a PhD in Peace Studies from the International Graduate School of Leadership Asia in Manila, Philippines.

Samuel Mwenda

Samuel Mwenda, MD is the General Secretary for the Christian Health Association of Kenya (CHAK). Dr. Mwenda was selected by the CCIH Board of Directors to receive the 2016 CCIH International Health Champion Award. He has used his skills and passion to build capacity of emerging health leaders and to advocate for the significant role of FBOs in delivering quality health services to the most vulnerable populations in Africa. As a result of his leadership, a milestone was achieved for FBOs, which was the signing of a Memorandum of Understanding to guide a public-private-partnership between the Government of Kenya and faith-based health providers.



Training the next generation of physicians for rural and under-served communities in North Carolina and around the world.

Nkatha Njeru

Nkatha Njeru, MPH is an experienced public health specialist who has worked with the faith sector in Kenya for the last 15 years. She has worked at health facilities and the organizational level, especially supporting health systems strengthening and grants management for faith based health facilities in Kenya. She is currently working on the AIDSFree project where IMA World health is mandated with demand creation for pediatric, adolescent and youth HIV services where she is piloting an innovative model for engagement of faith leaders. Ms. Njeru is also the coordinator of the Africa Christian Health Associations Platform (ACHAP).

Ngalande Ngalande, Jr.

Ngalande Ngalande, Jr., LLB is Advocacy Officer for the Churches Health Association of Zambia. Mr. Ngalande is a health rights advocate and has been working with civil society organizations in health rights in Zambia since 2008. He studied law and project management and worked on the

advocacy team that was instrumental in advocating against mandatory HIV testing and secured a court judgment in Zambia. He has demonstrated ability to easily transcend cultural differences and has been training community health workers in human rights and advocacy.

Theresa Nyamupachitu

Theresa Nyamupachitu, MSc serves as the Senior Program Advisor, Health Systems Strengthening (HSS) at IMA World Health. She has worked extensively on health systems strengthening and HIV/AIDS initiatives over the past 12 years. In her current role, she provides technical guidance to programs and organizational strengthening initiatives on HIV/AIDS and HSS. Ms. Nyamupachitu brings field experience from East, West, Southern Africa and Central Asia. She holds an MSc in International Health Policy and Management from Brandeis University and a Post Graduate Diploma in HIV/AIDS Management from The Milken Institute School of Public Health at George Washington University.



CHRISTIANITY|EXPLORED LIFE|EXPLORED
Engaging video-based resources that will help
you share the good news of Jesus.

the goodbook
COMPANY

Available from **thegoodbook.com**

Information about translations
www.ceministries.org/translations

CHRISTIANITY
EXPLOREDUSA
christianityexplored.us

David J. Olson

David Olson is a Communications and Social Marketing Consultant at Olson Global Communications. He is a technical advisor for social marketing programs in Mali and Zambia managed by Palladium (formerly Futures Group) and provides communications services to nonprofit organizations including Johns Hopkins University Center for Communication Programs. He was a Peace Corps volunteer in Togo and founded a grassroots network in Mali for Lutheran World Relief. He served as Director of Policy Communications at the Global Health Council from 2009-2011. Mr. Olson writes a monthly blog on global health at Global Health TV and serves as Secretary for the CCIH Board of Directors.

Daniel O'Neill

Daniel O'Neill, MD, MA(Th) is the Managing Editor of the Christian Journal for Global Health and an Assistant Clinical Professor of Family Medicine at the University of Connecticut School of Medicine. He completed a Masters of Theological Studies from Bethel Seminary, with specialised studies in a

Global Theology of Health. Dr. O'Neill has served as interim physician at Hospital Vozandes Del Oriente in Ecuador, as Medical Services Director for Medical Ministry International, and on multiple health and development projects including in Latin America, West Africa, the Middle East and North India. He is on the Board of Directors of the Center for Health in Mission.

Anne Peterson

Anne Peterson, MD, MPH is Senior Vice President of Global Programs at Americares. She began as a missionary in Kenya and Zimbabwe, consulted on Neglected Tropical Diseases for CDC and WHO and then moved into policy/political positions, first as Health Commissioner for the State of Virginia and then as Assistant Administrator for the Bureau for Global Health at USAID from 2001 to 2005. In that position, she oversaw all of USAID's global health programs in maternal and child health, AIDS, family planning, NTDs, health systems and the launch of the Bush administration's PEPFAR program. Dr. Peterson currently serves as the Board President of CCIH.



Sponsorship speaks.

Together, we tell kids with special needs:

- "You are not alone."*
Your sponsorship provides a compassionate caseworker to your child and their family.
- "You are loved."*
When you invest in a child with disabilities, you demonstrate that they are valued by you and by God. Your letters of encouragement and faith will be treasured.
- "You have potential."*
Our team of highly qualified physical and occupational therapists create a customized plan for each child, which includes therapy, family and community training, and specialized equipment.

Sponsor a child with disabilities today.
WorldHope.org/special-needs-child-sponsorship

 **WORLD HOPE**
INTERNATIONAL®

Marta Pirzadeh

Marta Pirzadeh, MPH has 20 years of experience with a primary focus on youth, maternal and infant health, HIV prevention and family planning. She is currently a Senior Technical Officer for the Research Utilization unit at FHI 360. Her responsibilities include synthesizing and disseminating evidence; developing programs; and providing TA to field activities. Under USAID's Advancing Partners & Communities Project, she works closely with CCIH to promote family planning within faith communities, both globally and with Ugandan partners. Ms. Pirzadeh has a MPH in Health Behavior and Health Education from the UNC Gillings School of Global Public Health.

Lance Plyler

Lance Plyler, MD is the Medical Advisor for Disaster Response and Programs at Samaritan's Purse. He received his undergraduate BS degree in physical therapy and postgraduate medical degree at University of North Carolina at Chapel Hill, and

completed an internship and residency in internal medicine at the University of Colorado. Dr. Plyler was involved in post-war recovery in Kosovo, post-earthquake and cholera responses in Haiti, refugee camp work in South Sudan, and field hospital deployment after Typhoon Haiyan. He was honored corporately with the "Ebola Fighters" as Time Magazine's 2014 Person of the Year.

Samuel Shanju

Samuel K. Shanju, HSM is a Program Assistant at the Ecumenical Pharmaceutical Network. He completed his degree in Health Systems Management at Kenya Methodist University in 2016. His background is in Pharmaceutical technology and he has worked in the Kenyan healthcare system for over eight years in various institutions including one of the largest mission referral hospitals in Kenya. At EPN he is involved in management of health and pharmaceutical projects in low- and middle income countries, especially in Sub-Saharan Africa. His expertise is in

Matt. 28:19 "GO..."

Medicine and Health Training to Go!



MMI (Missionary Medicine Intensive)

LENGTH: 2 weeks

COST: \$1,080* (includes food/lodging)

MMP (Missionary Medicine for Physicians)

LENGTH: 4 days

COST: \$990* (includes food/lodging)

CME Credit Option: \$1,320*

"One of the best CME courses I have attended in over 40 years of medicine."

—Mark R. Thorson, MD



Training to GO!

Equip International
PO Box 1126
Marion, NC 28752 USA

(828) 738-3891

equipinternational.org

For over 20 years Equip training has provided a range of practical skills, addressing the most basic of physical needs: water, food, shelter, sanitation and medicine. Ask about all our training classes.

promoting rational use of medicines, antimicrobial stewardship, training, procurement and supply chain management, advocacy and health systems strengthening.

Shepherd Smith

Shepherd Smith is President of the Institute for Youth Development. For more than 30 years he has been involved in HIV/AIDS, youth development, maternal and child health, nutrition, clean water and other poverty-focused development assistance from a faith-based perspective. His work has focused on both providing a solid foundation for US government implementation plans as well as a vision of funding for additional initiatives. He regularly participates in advocacy for broad PFDA issues related to UNAIDS, PEPFAR, The Global Fund, the Gates Foundation and others, with robust support of program implementation on every related project area.

David Stanton

David Stanton, MPH, MSN went to Liberia as a Peace Corps Volunteer and immediately fell in love with Africa and international public health in 1979. The AIDS pandemic became the logical focus of these two interests; shaping over 30 years of his professional career. Mr. Stanton joined USAID in 1997 as a technical advisor on HIV/AIDS. He became director of the Office of HIV/AIDS in 2012 and in September 2016 he stepped down to serve as the Office's Senior Science Leader. In December 2016 he was named Acting Deputy Assistant Administrator for Global Health.

Katie Taylor

Katie Taylor, MA is CEO and Founder of For Better Lives, LLC, a consulting firm focusing on children, youth, communities, and public health. Ms. Taylor has extensive experience in the private, public, and nonprofit sectors and has successfully led multi-million dollar businesses, turned around



The image shows a packet of Micro Mix, a food fortification product. The packet is red and yellow with a smiling sun character at the top left. The text on the packet includes 'Nora Lynne™', 'Micro Mix', 'MAMA PROJECT, INC.', 'FORTIFY FOOD DAILY WITH VITAMINS AND MINERALS', '21', and 'ESSENTIAL MICRONUTRIENTS FOR HEALTH'. The bottom of the packet shows a bowl of white rice.

Coming Soon

Micro Mix

For home food fortification with 21
Essential Micronutrients:

- Child Growth
- Immune System
- Anemia

Visit our booth for more information!

MAMA Project, Inc.
2781A Geryville Pike
Pennsburg, PA 18073
info@mamaproject.org
www.MAMAPROJECT.org



A circular inset image shows a young girl with dark hair, smiling and eating from a green bowl with a spoon.

organizations, and launched new initiatives and business lines. Most recently, she served as Deputy Assistant Administrator for Global Health at USAID. Her passion is to help mission-driven organizations make the world a better place—and to do so faster, better, smarter, and more creatively. Ms. Taylor serves on the Boards of Medical Teams International and Muso Health.

Donna Terpstra

Donna Terpstra is the Executive Director and Co-Founder of It's Our Mission: Period! After more than 20 trips throughout the continent of Africa and also living there for a time, Ms. Terpstra experienced many of the challenges women face there and began an active role in women's advocacy and empowerment, forming the nonprofit It's Our Mission: Period! to help equip women and girls in their monthly sanitary challenges. She boldly teaches: Women are created on purpose, and for His purpose. Her heart and soul is for women to learn the truth of who they are in Christ and to live their lives fully for Him.

Tonny Tumwesigye

Tonny Tumwesigye, MD, MSPH is the Executive Director of the Uganda Protestant Medical Bureau (UPMB), a national umbrella organization for Protestant, Adventist, and Pentecostal member health facilities in Uganda. Prior to his time at UPMB, Tonny served for nine years as the CEO of the 250-bed Mission Hospital in rural Uganda. Dr. Tumwesigye holds a Master of Science Degree in Public Health from the University of London/ London School of Hygiene and Tropical Medicine; as well as a Bachelor of Medicine and Bachelor of Surgery Degree from Makerere University in Kampala, Uganda.

Don Tyson

Don Tyson, PhD teaches undergraduate and graduate nursing at Eastern Mennonite University, while serving as the Director of the Master of Science in Nursing program. He has previous experience in clinical and administrative roles related to critical care, surgery, and quality improvement. Dr. Tyson graduated from Goshen



CBE International believes the Bible demands the full equality of women and men.

We envision a world free of patriarchy, where women and men lead and serve side by side as God intended.

Join the movement.
www.cbe.today/ccih

Women and men co-leading, co-serving, co-equal in Christ

"The most serious and unaddressed worldwide challenge is the deprivation and abuse of women and girls, largely caused by a false interpretation of carefully selected religious texts."

—Jimmy Carter



College in 1979 and the University of Virginia in 1986. He received his PhD in 2012 from George Mason University based on qualitative research related to the experience of African students in nursing programs in the US. While a student at GMU, he also did research on issues related to the uninsured, undocumented immigrants, and other international student issues.

Lauren Van Enk

Lauren Van Enk, MPH is a Program Officer at the Institute for Reproductive Health at Georgetown University, where she manages several family planning and reproductive health programs. She has over nine years of experience working in design, implementation and management of global reproductive and maternal health projects. She is particularly passionate about building the capacity of faith-based organizations and religious leaders in family planning and has provided this support across several countries in Africa. Ms. Van Enk holds a Master's degree in Global Public Health from

George Washington University and a BA from Calvin College.

Laura van Vuuren

Laura van Vuuren is a global health consultant with more than 25 years of experience in international health and development, including program design and management, training and capacity building, curriculum development and social and behavioral change. She has served in both management and technical roles with World Relief, Medical Teams International, the Academy for Educational Development, and Pennsylvania State University and served on the Board of CCIH between 2004 and 2012.

Rebecca J. Vander Meulen

Rebecca J. Vander Meulen, MPH serves as the Director of Community Health and Development in the Anglican Diocese of Niassa in Mozambique, where she has been living since 2003. Her responsibilities include staff development and



BLESSINGS

INTERNATIONAL®

MEDICINES FOR MISSIONS





EQUIPPING THOSE WHO SERVE THE SICK



VARIETY



AFFORDABILITY



SERVICE



EXPERIENCE

**LET US SUPPLY THE
RESOURCES FOR
YOUR MISSION**

Last year, Blessings International shipped over **254,000** pounds of medicine and supplies to **100** different nations.

**To review available medicines and supplies or to start the ordering process:
go to www.blessing.org; email info@blessing.org; or call 918-250-8101**

project design and evaluation. She received a Master of Public Health degree from Rollins School of Public Health, Emory University. Prior to her time in Mozambique, she worked in Washington, DC at Bread for the World.

Julie Varughese

Julie Varughese, MD serves as Medical Officer at AmeriCares. She is responsible for increasing access to quality medicine for low-income patients in more than 90 countries. She shapes health programs to enhance patient care, provides medical oversight and reviews offers of donated products from over 200 pharmaceutical and medical supply companies, ensuring the items are used safely and effectively by AmeriCares health care partners around the globe. Dr. Varughese also oversees AmeriCares Medical Outreach program, which supplies medical products to US-based health care professionals traveling overseas to provide care and surgeries for patients in desperate need.

Amy Wilson

Amy Wilson works for Crisis Care Training International and has been working in the mission world since 2008. She graduated from Meredith College with degrees in Psychology and Education. Ms. Wilson has worked with children in Thailand and many Latin American countries, including Mexico City where she and her family lived for a year and a half. God brought her to work with Crisis Care Training International in 2012, which is under the umbrella of Worldwide Evangelization for Christ. Her work includes editing and training others with the wide variety of resources that CCTI offers.

Joan Geiger Wood

Joan Geiger Wood is a Certified Fundraising Executive with extensive experience developing and implementing successful fundraising programs, having raised over \$115 million for non-profit organizations during a 25+ year career. Ms. Wood is principal at Joan Wood & Company where

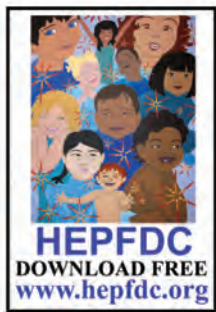

Health Education Program For Developing Communities (HEPFDC)

Available in English, French, Hmong, Indonesian,
Khmer, Mandarin, Russian and Spanish

DOWNLOAD FREE at www.hepfdc.info

The HEPFDC is used by physicians and other healthcare providers, teachers, community health workers, pastors and churches in the U.S. and throughout the world.

The WHO life-saving, evidence-based information integrates community health with primary care and is used at all levels of healthcare (Hospital, clinic, as well as community).

It also enables the Church, regardless of size or resources (in the U.S. as well as developing countries) to re-assume its responsibilities for the provision of Biblically-based, wholistic health and healing.

Links to participatory *Lesson Plan* and *Picture Book* versions developed by Global CHE Network assist Community Health Educators (CHEs) in implementing the participatory approach to learning.

We have also been blessed with a grant for **FREE HARD COPIES** if left with developing community health educators. Please contact arnoldgorske@gmail.com for additional information.

she works with nonprofits to improve fundraising systems and build successful development programs. A member of the Association of Fundraising Professionals, she currently serves on the board of the AFP DC chapter, is Vice-President of Education for the chapter and was co-chair of the 2015 National Capital Philanthropy Day celebration.

Peter Yeboah

Peter Yeboah, MPH, MSc is the Executive Director of the Christian Health Association of Ghana (CHAG), which is the second largest Provider of health services in Ghana. Mr. Yeboah has been involved in health system strengthening initiatives over the course of his professional life spanning a 21-year period at all levels of CHAG. He was instrumental in formulating the partnership agreement signed between CHAG and the Government of Ghana in 2006. In 2015, he was appointed as a Member of the Presidential

Committee tasked to review Ghana's National Health Insurance Scheme. In February 2017, he was elected as the Chairman of the Africa Christian Health Associations Platform (ACHAP).

Dottie Yunger

Reverend Dottie Yunger, MDiv is Lead Pastor at Solomon's United Methodist Church. Prior to this, Reverend Yunger served as the Associate Pastor at Metropolitan Church in Washington, DC. After serving as a marine biologist and environmental educator for the Smithsonian Institution and Discovery Channel for many years, she became the Anacostia Riverkeeper and Executive Director in 2008. In 2009, she was awarded the Living Legend Award by Living Classrooms for her dedication to the Anacostia River. Reverend Yunger received her Bachelor of Science in Marine Biology from the University of Maryland and a Master's of Divinity and Master's of Theological Studies from Wesley Theological Seminary.

“Health care is not only everyone's right, but everyone's responsibility.” — *Where There Is No Doctor*

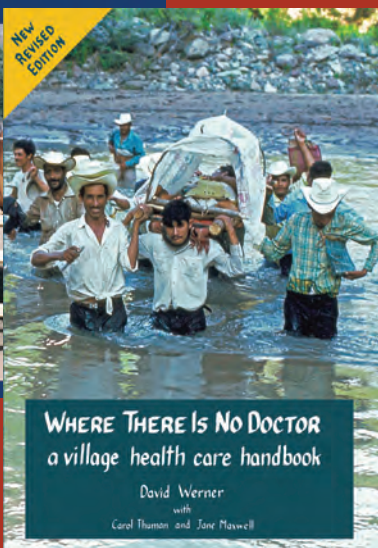
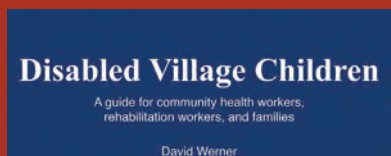

Missionaries, community health workers, teachers, and health advocates work hard to put this idea into practice.

To assist your work, Hesperian resources such as *Where There Is No Doctor* provide practical information and effective strategies for improving health in the community.

To recognize and further your amazing work, Hesperian is offering you **20% off all titles**, now through August 15th.

USE COUPON CODE "CCI17" AT CHECKOUT TO SAVE

Visit our online store to learn about our books like *Where There Is No Dentist*, *Helping Children Who are Deaf*, and *Helping Health Workers Learn*.
VISIT US ONLINE: store.hesperian.org



NOTES



Global Health Council

The Collective Voice of the Global Health Community

Please join us as we seek to re-launch the **Faith and Global Health** efforts, in collaboration with the Global Health Council on **Monday July 17th at 5 pm**

Conference Rooms 1 and 2 of the UMC General Board of Church and Society offices at

100 Maryland Avenue, NE, just off Capitol Hill

A subset of active members from the former caucus have been gathering to launch this effort.

This first meeting would seek to establish a charter for the renewed group as:

- a best practice/knowledge hub and exchange about faith-based health practices;
- a fellowship centered space to share the role of faith in our lives and work and gather strength; and
- an advocacy aware (but not advocacy driven) place to highlight efforts by a variety of entities.

We hope to convene quarterly salons based on the three elements above and including topical/themed in-depth presentations; rapid fire/speed dating rounds to highlight initiatives underway or completed; advocacy “speed” rounds (info sharing); and a “faith matters” segment as witness to faith in our work.

People of all faiths are welcome

NOTES

